

1. Running activities on the wheels

- Racks Installation
 - Cable Chain Rack
 - Radial cables trays
 - Periphery cables trays
 - Supports for cables extra-length on towers
 - HV and LV Patch panels
-
- Others
 - Alignment Interface board positioning
 - Hall Probes. CAN-Nodes.
 - HO-RBx position and optical fibers routing on YB0.

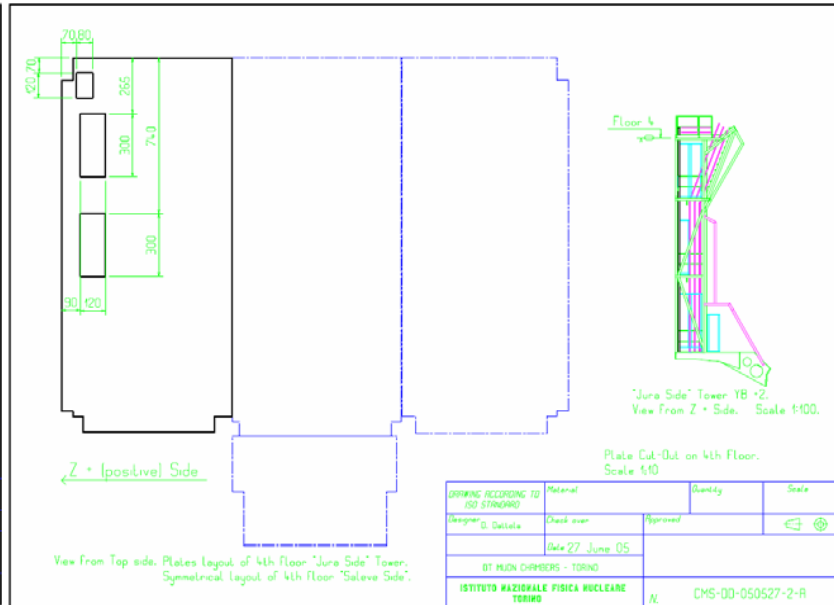
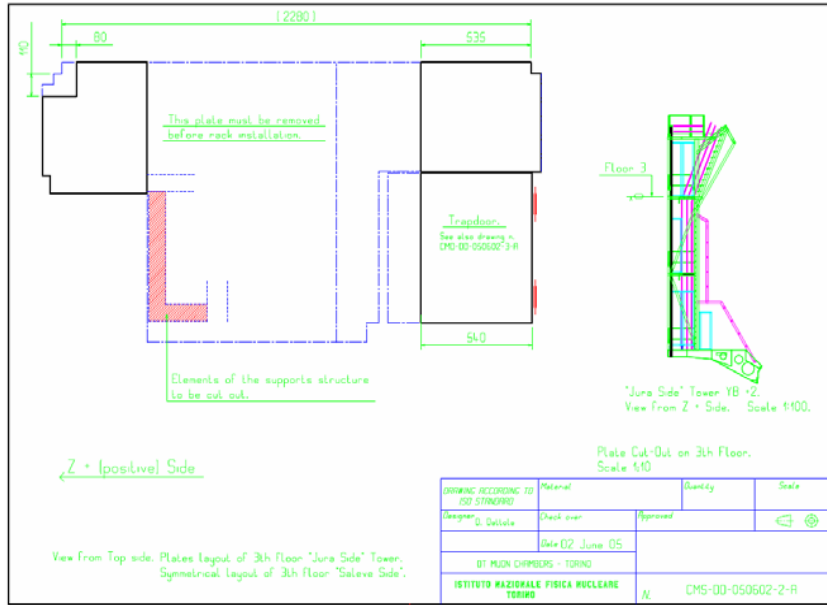
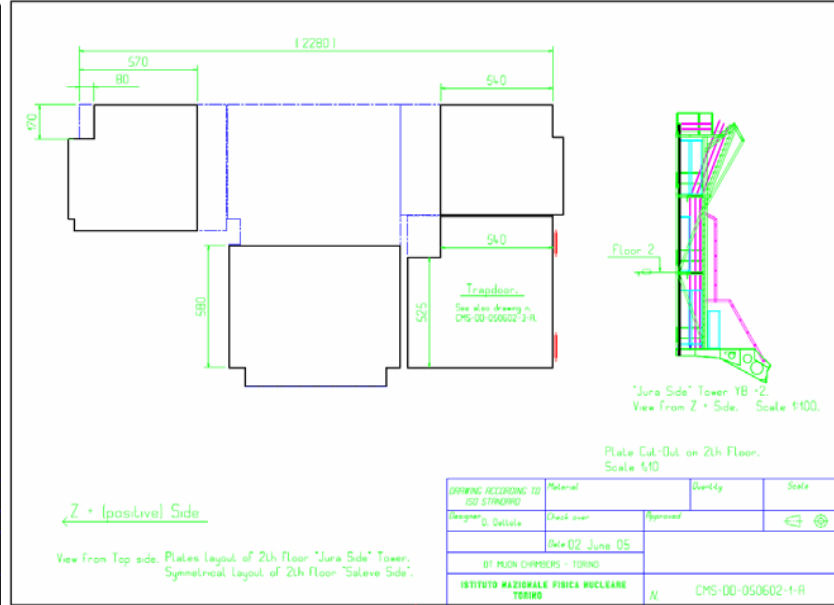
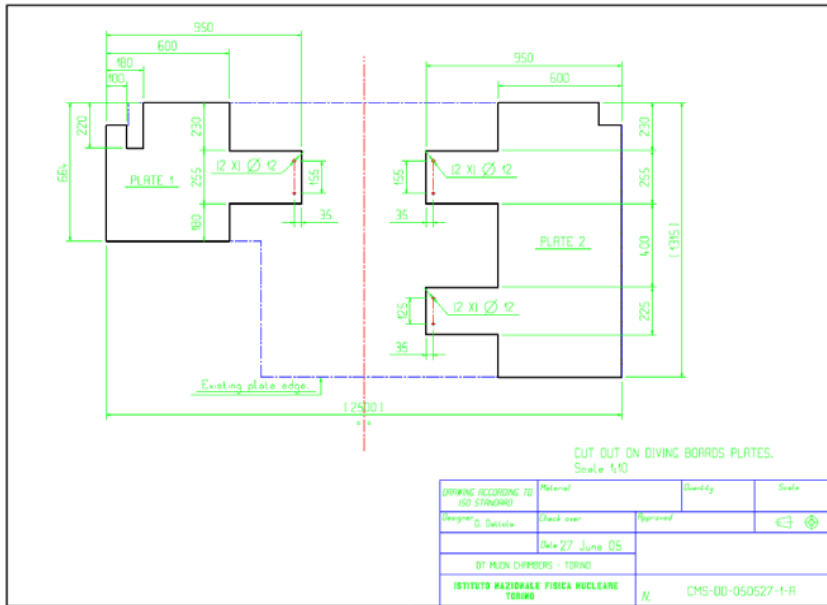

Detail racks position on Diving Board

Secl. A-A

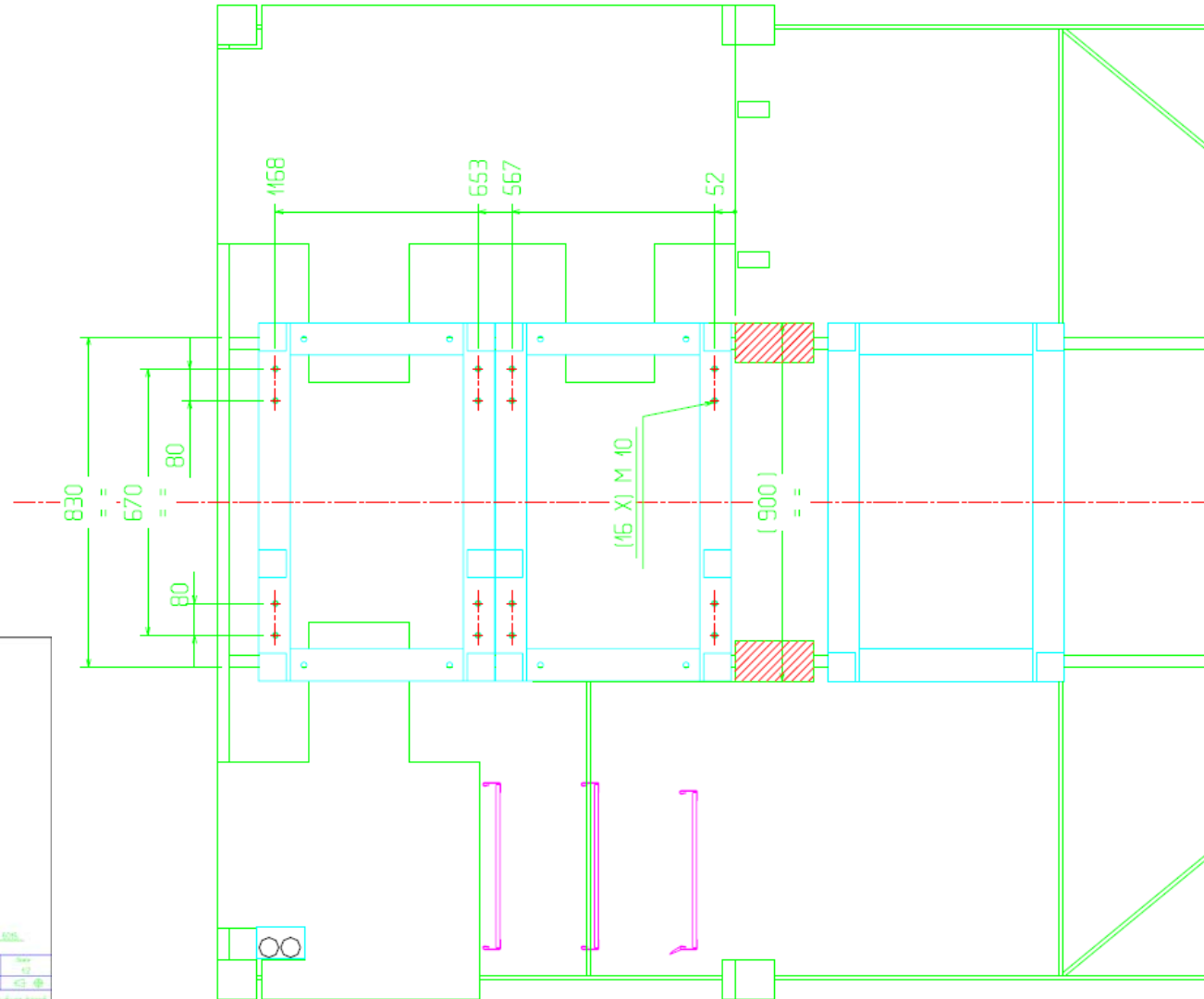

DB Racks foot.

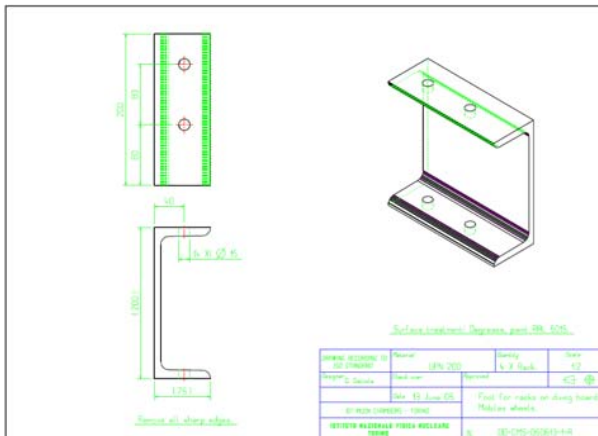

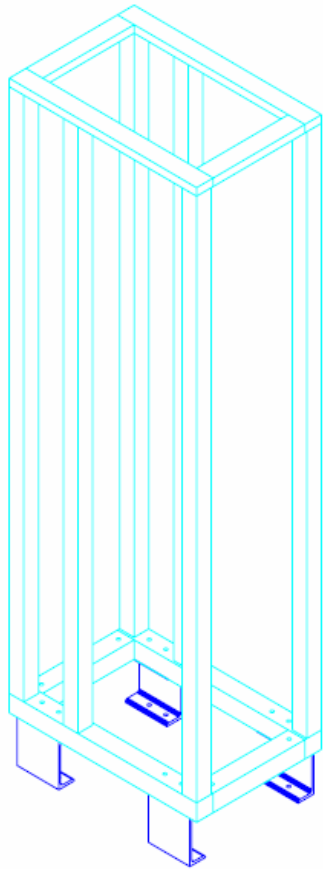

Rack with foot. Only for installation on diving boards of mobiles wheels.

Note:

Group A holes for racks on diving boards of mobiles wheels.

Group B holes for rack of 2nd and 3rd tower floor.

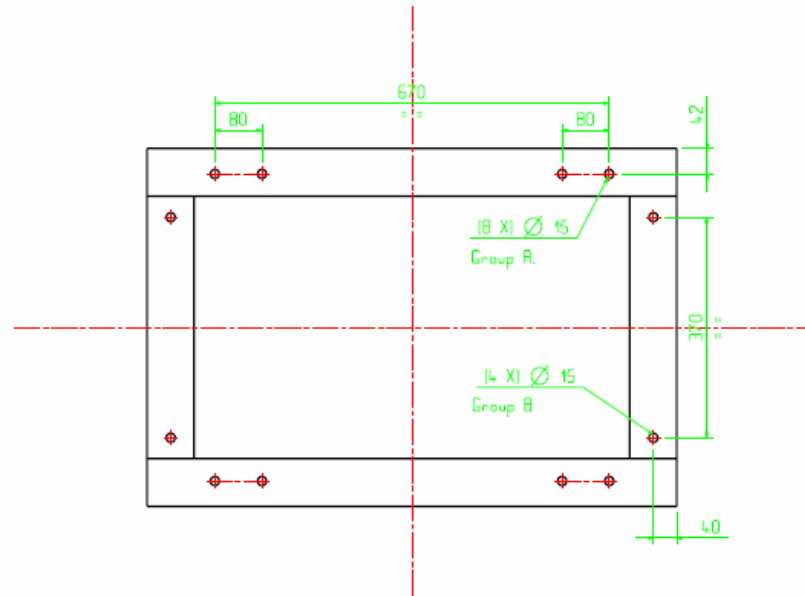

HOLES ON RACKS FOOTPRINT.

Scale 1:5

Pos.	Code	Descrizione	N. Pezzi	Massa unitaria	Note
		Materiale grezzo - Componenti			
	Superficie	Quote senza indicazione di tolleranza (muschi non quotati) Grado di precisione medio UNI 5307	1 X 45°		Scale 1:10
Dis.	D. Detollo	Note			⚠
Date	12 June 05	Firma	Denominazione RACKS FIXING HOLES.		
		DT MUON CHAMBERS - TORINO			
		ISTITUTO NAZIONALE FISICA NUCLEARE TORINO	N.	CMS-DD-050613-2-A	

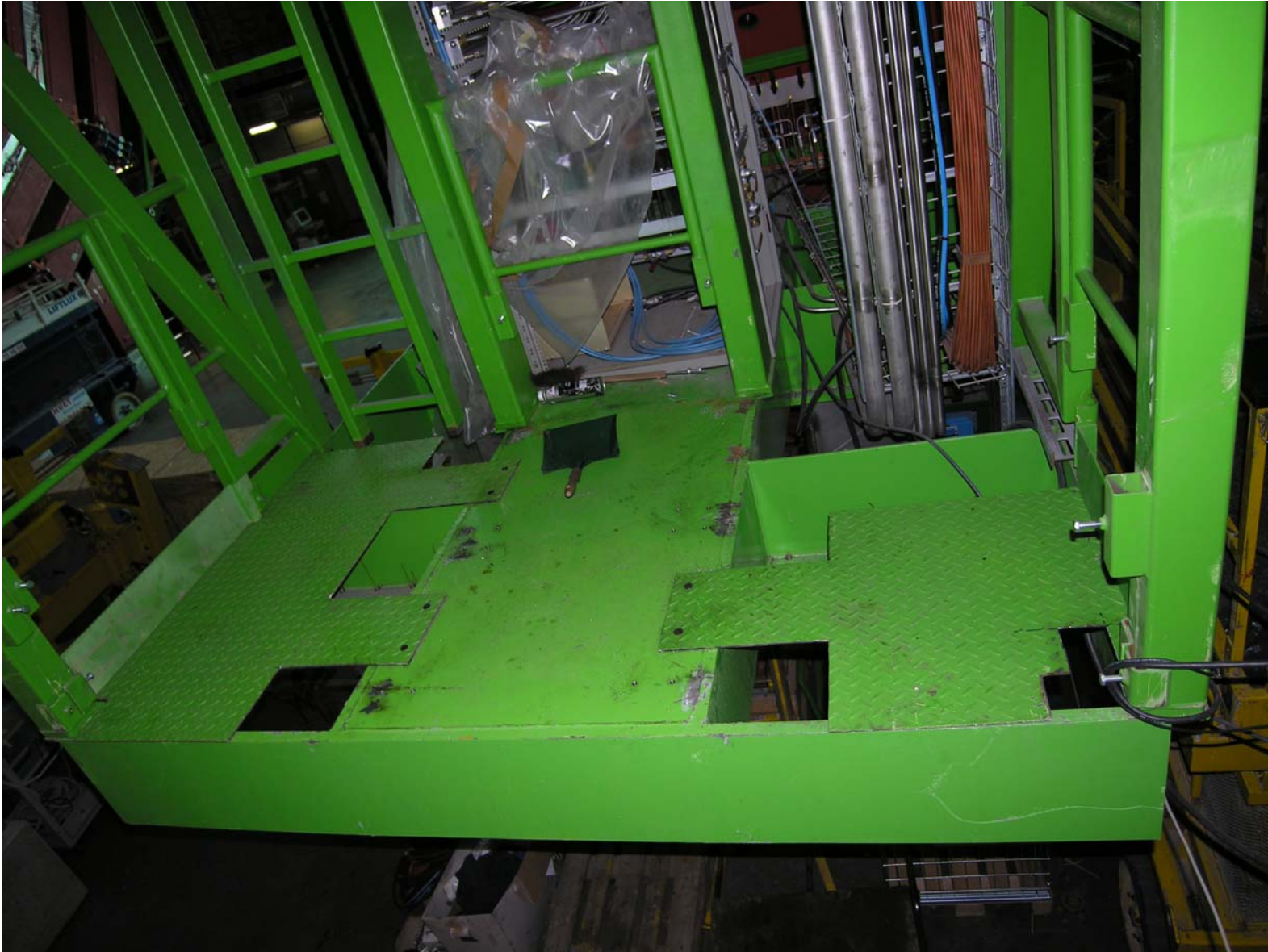



Details still to be fixed



DRAFT

DRAFT

U	Lowest LV RACK - X2J22		DP																		
			[W]																		
2	DT Slow Ctrl PP																				
4	Rack ctrl + power																				
2	Distributor of cables on a 2U or 1U heat exchanger																				
6	RPC LV crate	<table border="1"> <thead> <tr> <th>MODULE</th> <th>Layer</th> <th>Sect.</th> </tr> </thead> <tbody> <tr> <td>4-A3009</td> <td>all</td> <td>10</td> </tr> <tr> <td>4-A3009</td> <td>all</td> <td>11</td> </tr> <tr> <td>4-A3009</td> <td>all</td> <td>12</td> </tr> <tr> <td>2-A3801</td> <td>all</td> <td>1,2,3,10,11,12</td> </tr> <tr> <td>- not used -</td> <td></td> <td></td> </tr> </tbody> </table>	MODULE	Layer	Sect.	4-A3009	all	10	4-A3009	all	11	4-A3009	all	12	2-A3801	all	1,2,3,10,11,12	- not used -			
MODULE	Layer	Sect.																			
4-A3009	all	10																			
4-A3009	all	11																			
4-A3009	all	12																			
2-A3801	all	1,2,3,10,11,12																			
- not used -																					
3	AC/DC 2 [KW]	AC/DC 2 [KW]																			
2	Distributor of cables on a 2U or 1U heat exchanger (where needed)																				
6	DT LV crate	<table border="1"> <thead> <tr> <th>MODULE</th> <th>Layer</th> <th>Sect.</th> </tr> </thead> <tbody> <tr> <td>4-A3080 DT-DIG3V3</td> <td>1, 2</td> <td>12</td> </tr> <tr> <td>4-A3080 DT-DIG3V3</td> <td>3, 4</td> <td>12</td> </tr> <tr> <td>4-A3009 DT-DIG5V, DT-AN</td> <td>all</td> <td>12</td> </tr> <tr> <td>4-A3100 SECT. COL.</td> <td>crate</td> <td></td> </tr> <tr> <td>4-A3100 SECT. COL.</td> <td>crate</td> <td></td> </tr> </tbody> </table>	MODULE	Layer	Sect.	4-A3080 DT-DIG3V3	1, 2	12	4-A3080 DT-DIG3V3	3, 4	12	4-A3009 DT-DIG5V, DT-AN	all	12	4-A3100 SECT. COL.	crate		4-A3100 SECT. COL.	crate		
MODULE	Layer	Sect.																			
4-A3080 DT-DIG3V3	1, 2	12																			
4-A3080 DT-DIG3V3	3, 4	12																			
4-A3009 DT-DIG5V, DT-AN	all	12																			
4-A3100 SECT. COL.	crate																				
4-A3100 SECT. COL.	crate																				
3	AC/DC 2 [KW]	AC/DC 2 [KW]																			
2	Distributor of cables on a 2U or 1U heat exchanger (where needed)																				
6	DT LV crate	<table border="1"> <thead> <tr> <th>MODULE</th> <th>Layer</th> <th>Sect.</th> </tr> </thead> <tbody> <tr> <td>4-A3080 DT-DIG3V3</td> <td>1, 2</td> <td>11</td> </tr> <tr> <td>4-A3080 DT-DIG3V3</td> <td>3, 4</td> <td>11</td> </tr> <tr> <td>4-A3009 DT-DIG5V, DT-AN</td> <td>all</td> <td>11</td> </tr> <tr> <td>4-A3009F ALIGNMENT</td> <td>ENDCAP</td> <td></td> </tr> <tr> <td>4-A3009F ALIGNMENT</td> <td>LINK</td> <td></td> </tr> </tbody> </table>	MODULE	Layer	Sect.	4-A3080 DT-DIG3V3	1, 2	11	4-A3080 DT-DIG3V3	3, 4	11	4-A3009 DT-DIG5V, DT-AN	all	11	4-A3009F ALIGNMENT	ENDCAP		4-A3009F ALIGNMENT	LINK		
MODULE	Layer	Sect.																			
4-A3080 DT-DIG3V3	1, 2	11																			
4-A3080 DT-DIG3V3	3, 4	11																			
4-A3009 DT-DIG5V, DT-AN	all	11																			
4-A3009F ALIGNMENT	ENDCAP																				
4-A3009F ALIGNMENT	LINK																				
3	AC/DC 2 [KW]	AC/DC 2 [KW]																			
2	Distributor of cables on a 2U or 1U heat exchanger (where needed)																				
6	DT LV crate	<table border="1"> <thead> <tr> <th>MODULE</th> <th>Layer</th> <th>Sect.</th> </tr> </thead> <tbody> <tr> <td>4-A3080 DT-DIG3V3</td> <td>1, 2</td> <td>10</td> </tr> <tr> <td>4-A3080 DT-DIG3V3</td> <td>3, 4</td> <td>10</td> </tr> <tr> <td>4-A3080 DT-DIG3V3</td> <td>4₁₁</td> <td>10</td> </tr> <tr> <td>4-A3009 DT-DIG5V</td> <td>all</td> <td>10</td> </tr> <tr> <td>4-A3009 DT-AN5V, DT-AN2</td> <td>all</td> <td>10</td> </tr> </tbody> </table>	MODULE	Layer	Sect.	4-A3080 DT-DIG3V3	1, 2	10	4-A3080 DT-DIG3V3	3, 4	10	4-A3080 DT-DIG3V3	4 ₁₁	10	4-A3009 DT-DIG5V	all	10	4-A3009 DT-AN5V, DT-AN2	all	10	
MODULE	Layer	Sect.																			
4-A3080 DT-DIG3V3	1, 2	10																			
4-A3080 DT-DIG3V3	3, 4	10																			
4-A3080 DT-DIG3V3	4 ₁₁	10																			
4-A3009 DT-DIG5V	all	10																			
4-A3009 DT-AN5V, DT-AN2	all	10																			
3	AC/DC 2 [KW]	AC/DC 2 [KW]																			
1	heat exchanger																				
2	Deflector																				
2	DT Slow Ctrl PP																				

55 U used

0

1 U free

F. Montecassiano INFN Pd @ CERN EP/CMM

Last update 07.02.2005

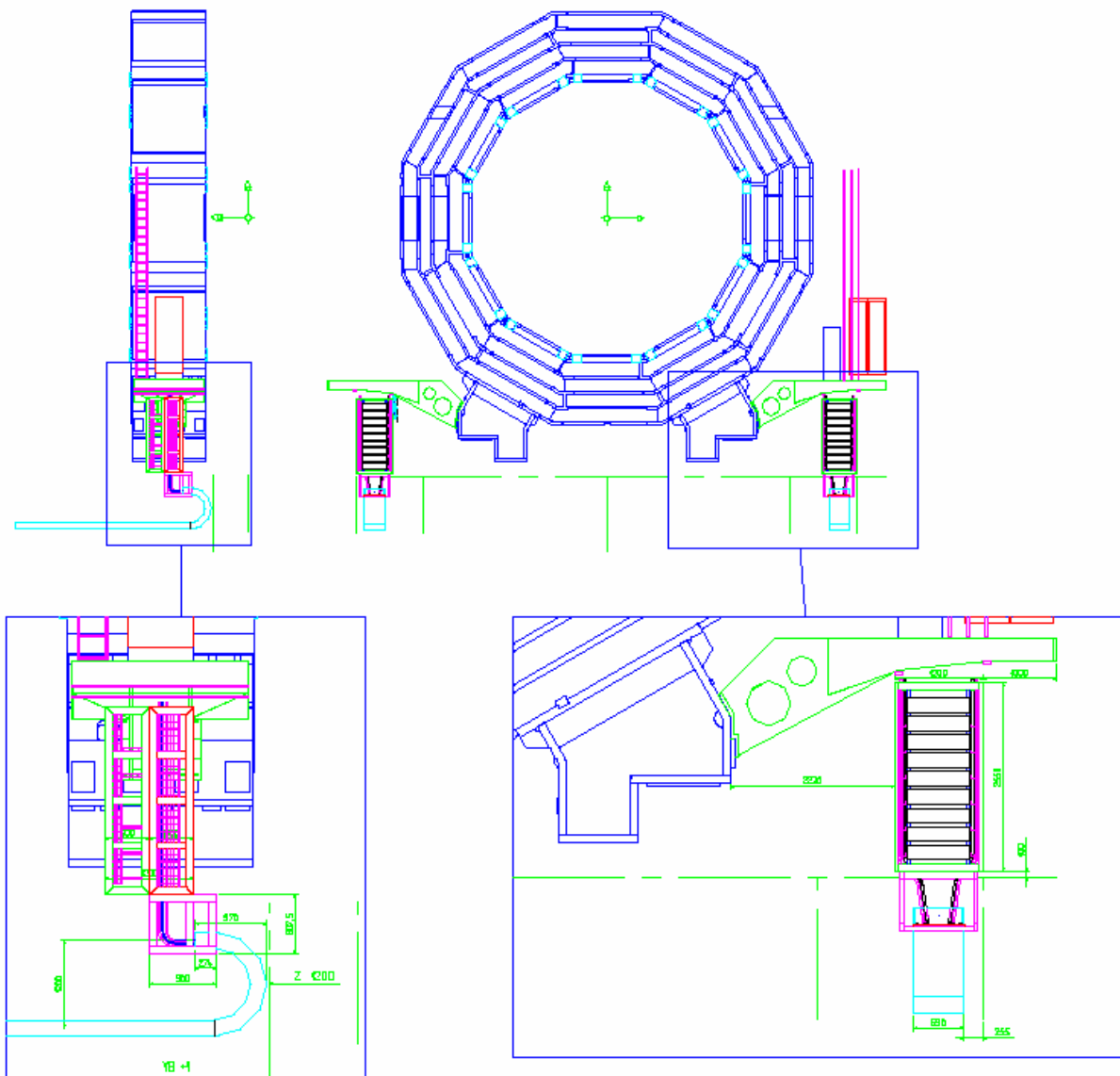

DRAFT

Pos.	Coll.	Descrizione	St.	Mod.	Aut.
Proj.		Modulo sistema "CableChain"	01		
Approv.		Modulo sistema "CableChain" con sistema di gestione dati	02		
Dis.	di sistema	Modulo sistema "CableChain"	03		
Dis.	di sistema	Modulo sistema "CableChain"	04		
Dis.		Modulo sistema "CableChain"	05		
Dis.		Modulo sistema "CableChain"	06		
Dis.		Modulo sistema "CableChain"	07		
Dis.		Modulo sistema "CableChain"	08		
Dis.		Modulo sistema "CableChain"	09		
Dis.		Modulo sistema "CableChain"	10		
Dis.		Modulo sistema "CableChain"	11		
Dis.		Modulo sistema "CableChain"	12		
Dis.		Modulo sistema "CableChain"	13		
Dis.		Modulo sistema "CableChain"	14		
Dis.		Modulo sistema "CableChain"	15		
Dis.		Modulo sistema "CableChain"	16		
Dis.		Modulo sistema "CableChain"	17		
Dis.		Modulo sistema "CableChain"	18		
Dis.		Modulo sistema "CableChain"	19		
Dis.		Modulo sistema "CableChain"	20		
Dis.		Modulo sistema "CableChain"	21		
Dis.		Modulo sistema "CableChain"	22		
Dis.		Modulo sistema "CableChain"	23		
Dis.		Modulo sistema "CableChain"	24		
Dis.		Modulo sistema "CableChain"	25		
Dis.		Modulo sistema "CableChain"	26		
Dis.		Modulo sistema "CableChain"	27		
Dis.		Modulo sistema "CableChain"	28		
Dis.		Modulo sistema "CableChain"	29		
Dis.		Modulo sistema "CableChain"	30		
Dis.		Modulo sistema "CableChain"	31		
Dis.		Modulo sistema "CableChain"	32		
Dis.		Modulo sistema "CableChain"	33		
Dis.		Modulo sistema "CableChain"	34		
Dis.		Modulo sistema "CableChain"	35		
Dis.		Modulo sistema "CableChain"	36		
Dis.		Modulo sistema "CableChain"	37		
Dis.		Modulo sistema "CableChain"	38		
Dis.		Modulo sistema "CableChain"	39		
Dis.		Modulo sistema "CableChain"	40		
Dis.		Modulo sistema "CableChain"	41		
Dis.		Modulo sistema "CableChain"	42		
Dis.		Modulo sistema "CableChain"	43		
Dis.		Modulo sistema "CableChain"	44		
Dis.		Modulo sistema "CableChain"	45		
Dis.		Modulo sistema "CableChain"	46		
Dis.		Modulo sistema "CableChain"	47		
Dis.		Modulo sistema "CableChain"	48		
Dis.		Modulo sistema "CableChain"	49		
Dis.		Modulo sistema "CableChain"	50		

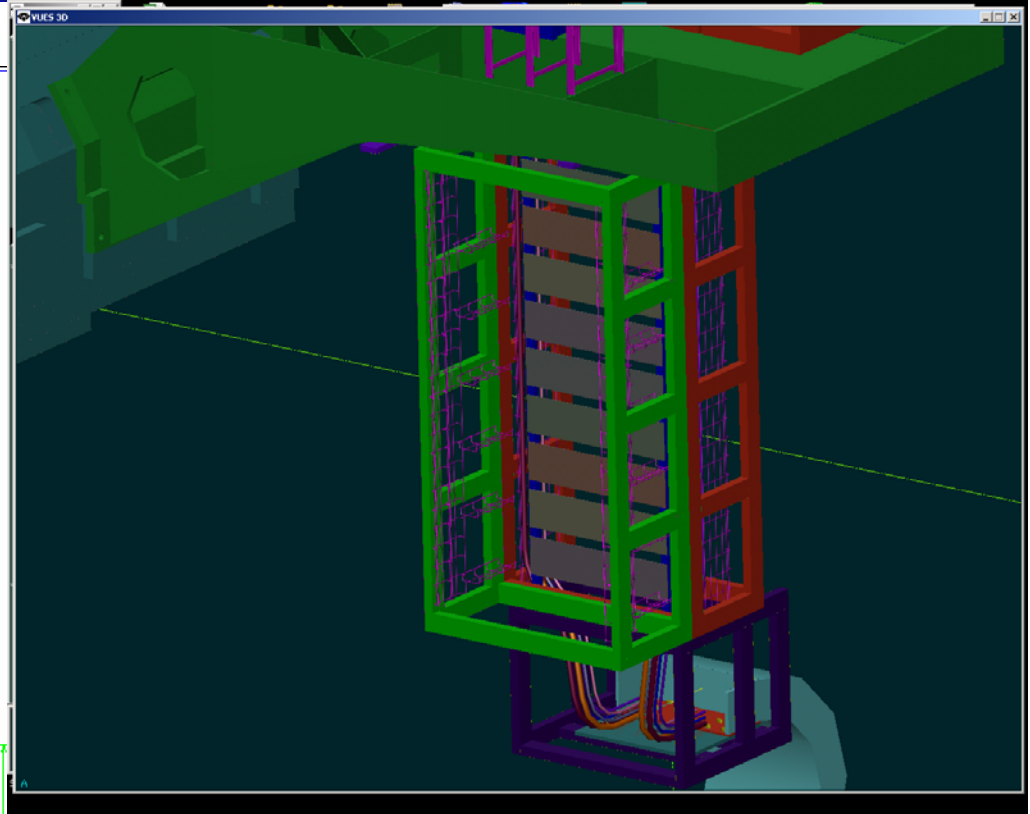
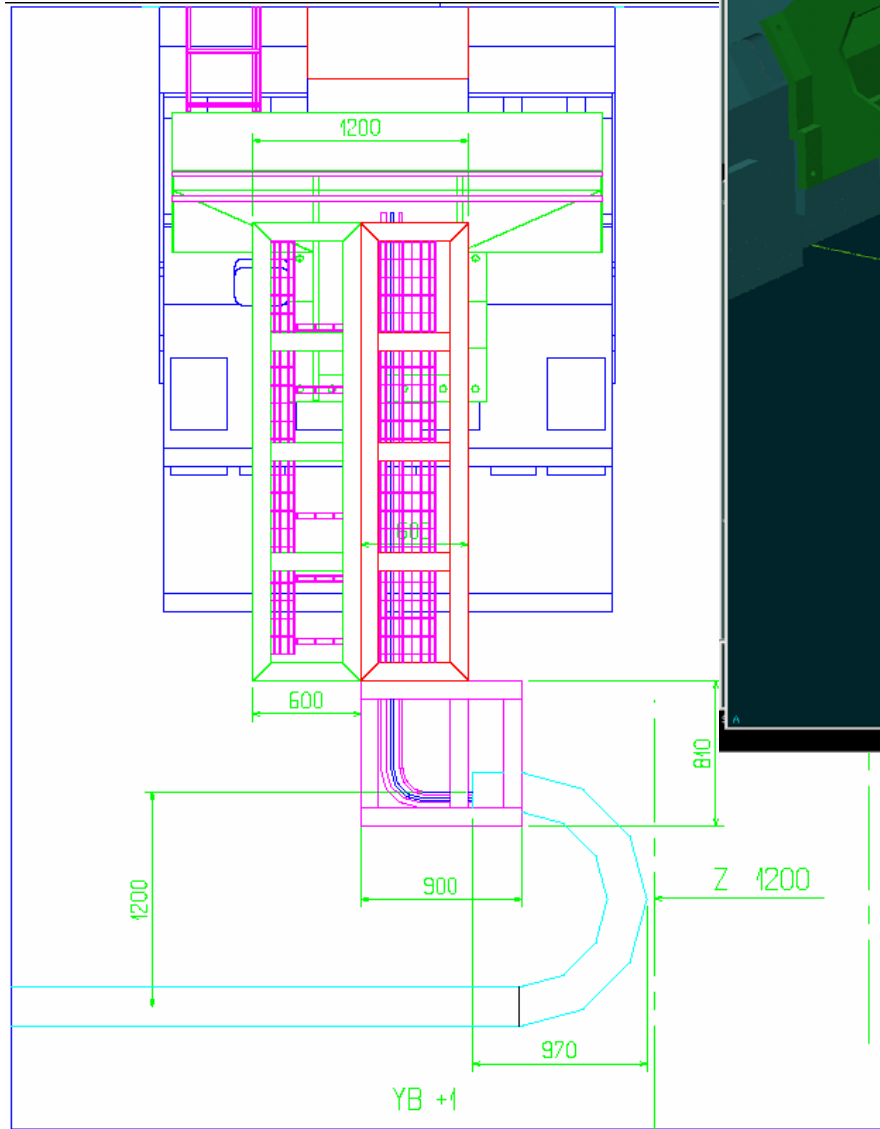

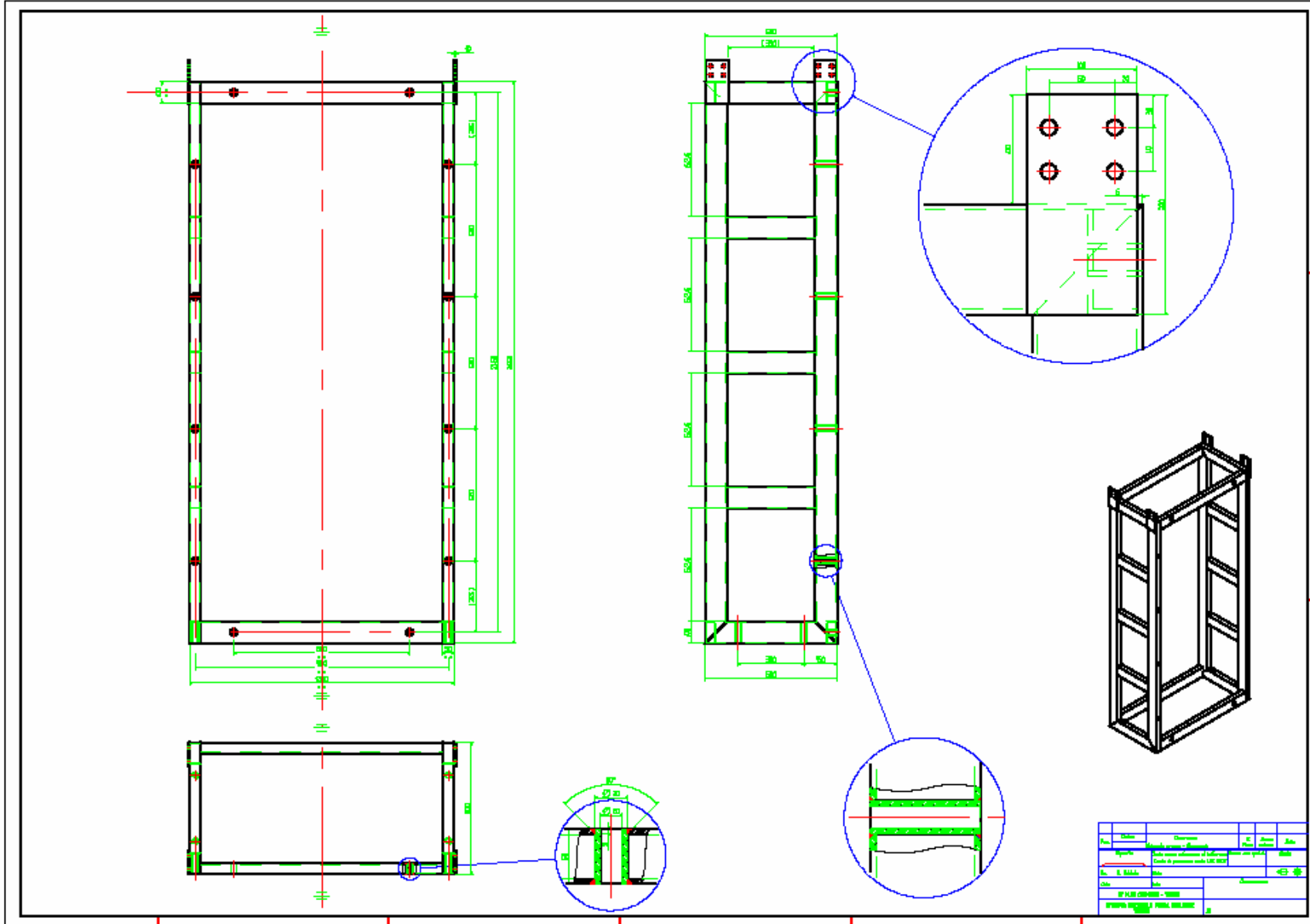

Standard components:

Flexrails:

Tolmega C75. Steel. Electro zinc

Wire mesh cable tray:

CF 54/300, CF 54/100. Steel. GC

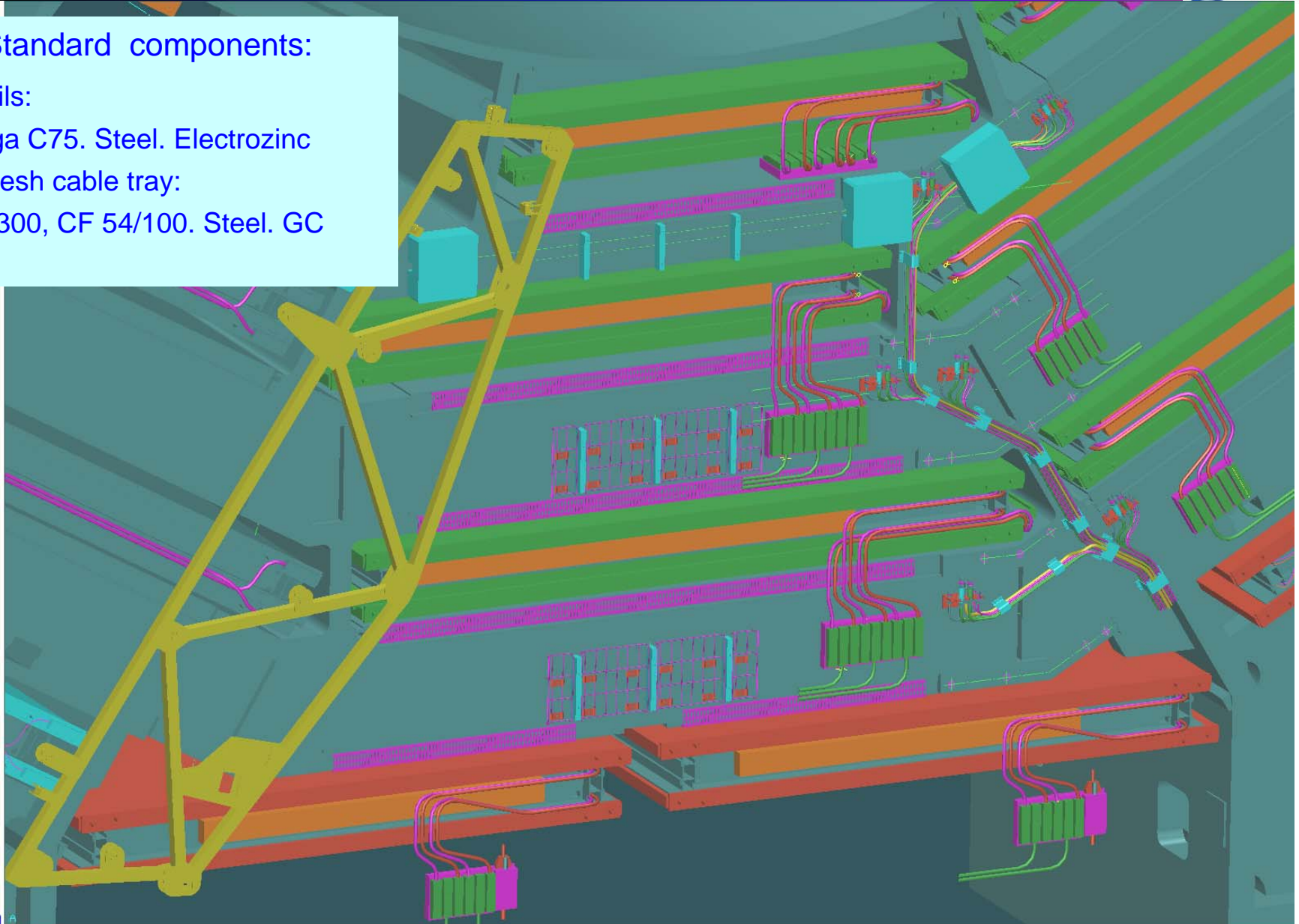

Radial cables path components and ancillaries for fixing are ready, but, Cablofil WireMesh are not conform to the design extracted from Cablofil catalog.

Thermal screen cover design to be finalized.

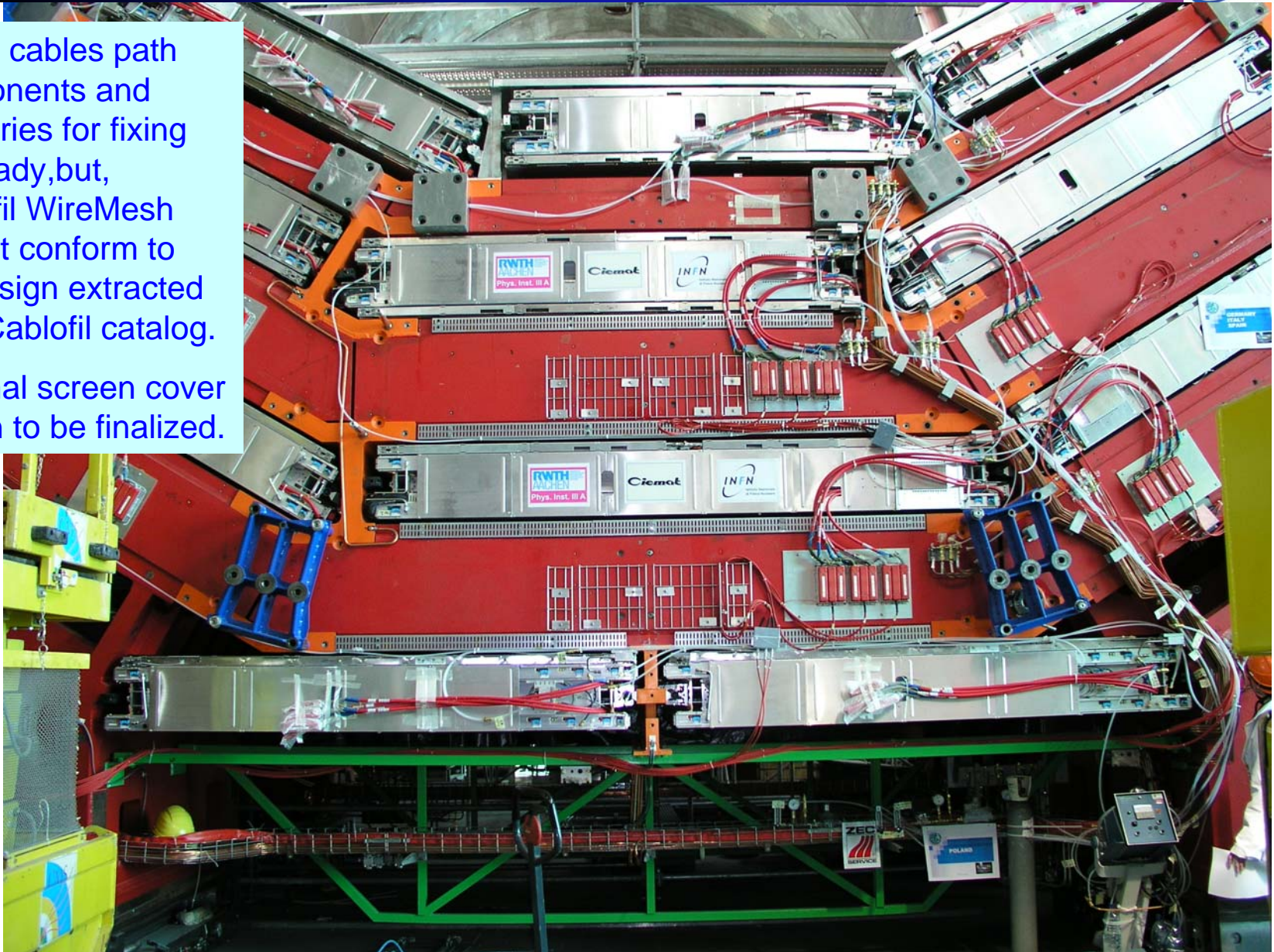

Muon Barrel. Radial Cables Ways and services components status

Services fixing tapered holes	MB1; 2; 3 :Completed on all the wheels.	MB4 : Desing in work
	Note: New LV PP layout require new holes on the iron !	
MB1 fix plate rails	Installed on YB2	To be produced for all the remaining YB
HV fixing plate		
HV MB1	Installed YB2.	To be produced for all the remaining YB
HV MB2/3	Installed on YB2.	To be produced for all the remaining YB
HV MB4	Design in work	
LV fixing plate		
LV MB1/MB2	Design ready for manufacture	
LV MB3	Partly installed on YB2.	
LV MB4	Design in work	
Wire mesh Cable ways	Defined. To be order	
Fixing parts	Delivered @ Pt 5	
Flexrail	Delivered @ Pt 5	
Fixing parts	Delivered @ Pt 5	
Services Cover/Thermal screen	Proposal. In work	

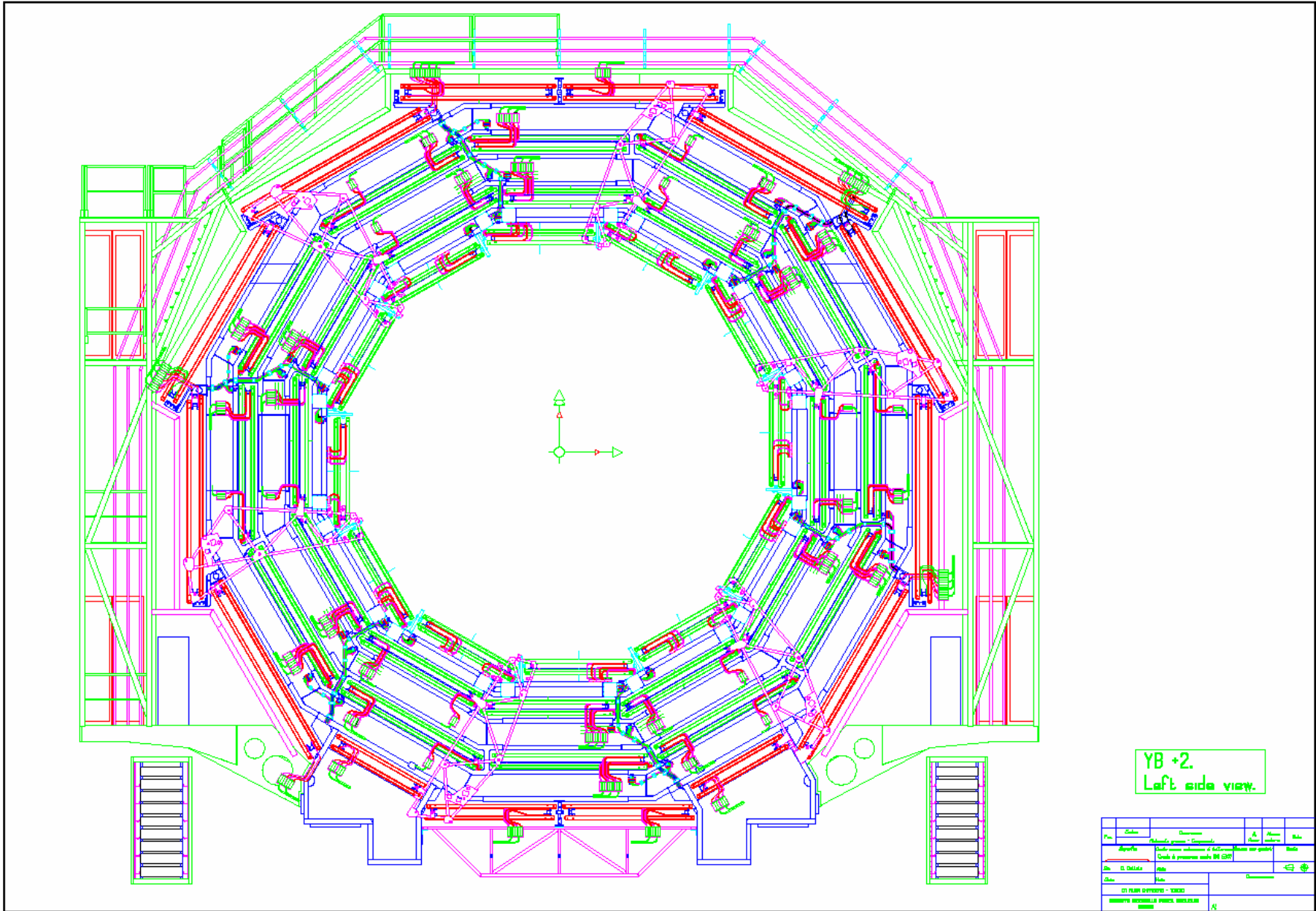

YB +2.
Left side view.

Rev.	Descrizione	Aut.	Appr.	Data
01	Albergo
02
03
04
05
06
07
08
09
10
11
12
13
14
15
16
17
18
19
20
21
22
23
24
25
26
27
28
29
30
31
32
33
34
35
36
37
38
39
40
41
42
43
44
45
46
47
48
49
50

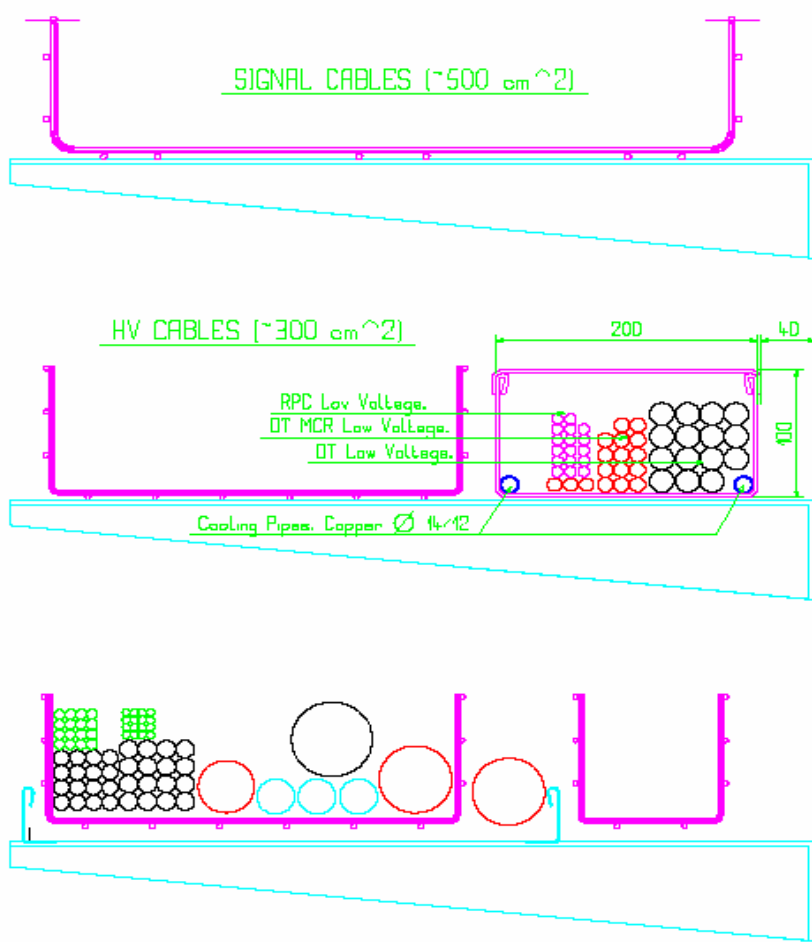

Upper side typical cross section.

Drawings for installation and material ready. Installation is foreseen to start just after racks mounting on towers.

Optical fibers channel still to be defined.

Periphery Cable tray.

D.D. 050221

Aut.	D. Debole	Abbr.		
Coll.		Verbo		Demarcazione
ISTITUTO NAZIONALE FISICA NUCLEARE TORINO			N	

Muon Barrel.
Upper Side Periphery Cables Ways components status

1st Layer		
Gas-Cooling		Completed
Spare cable tray	Cablofil wire mesh 100 X 150	Delivered
2nd Layer		
Cooled LV	Tolmega 100 X 200	Delivered
DT-RPC Signal	Cablofil wire mesh 100 X 300	Delivered
3rd Layer		
DT-RPC HV	Cablofil wire mesh 100 X 500	Delivered
Optical fiber	Detailed list of components in preparation.	To be ordered



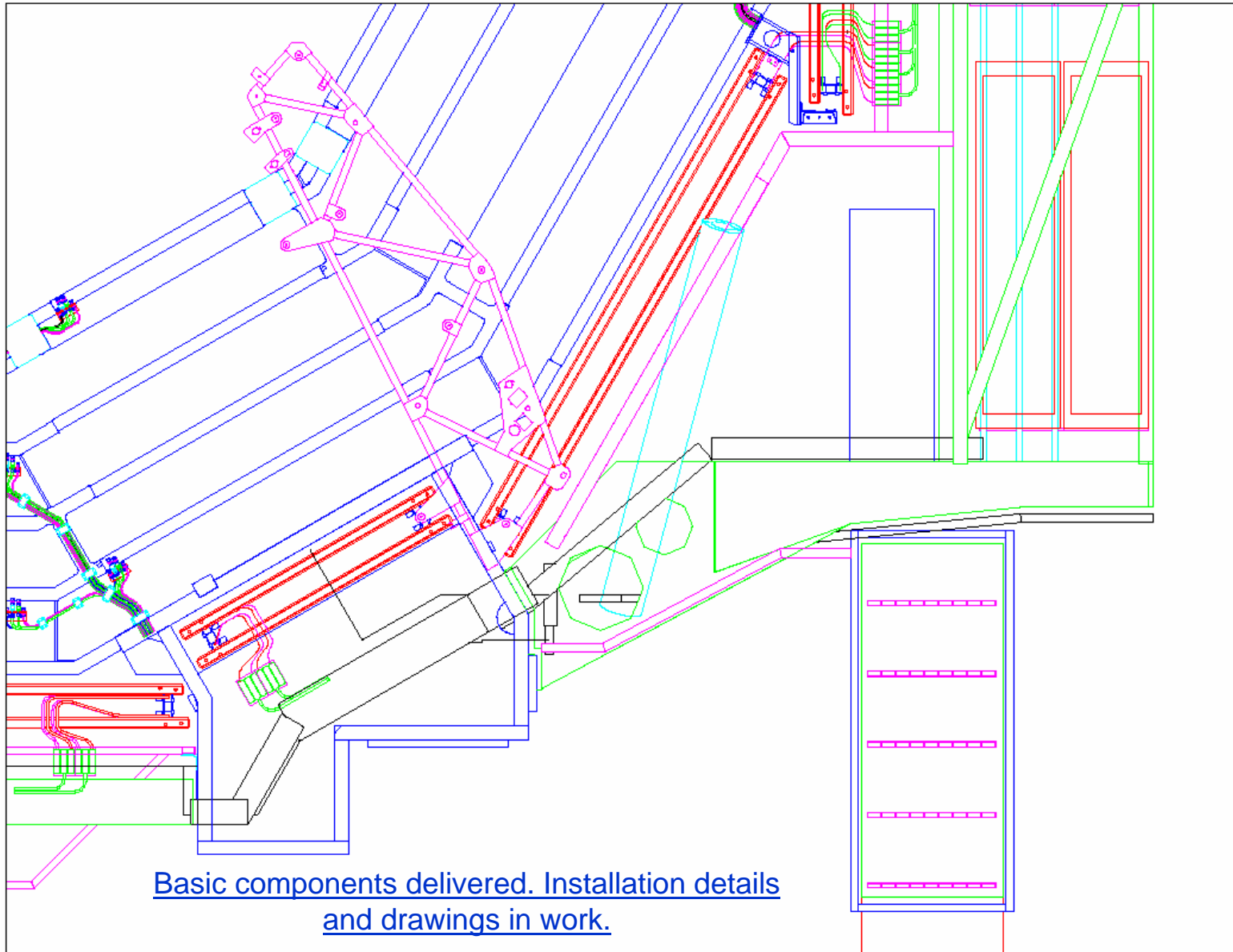

To be detailed:

- Structures to store cables overlenght on the walkway.

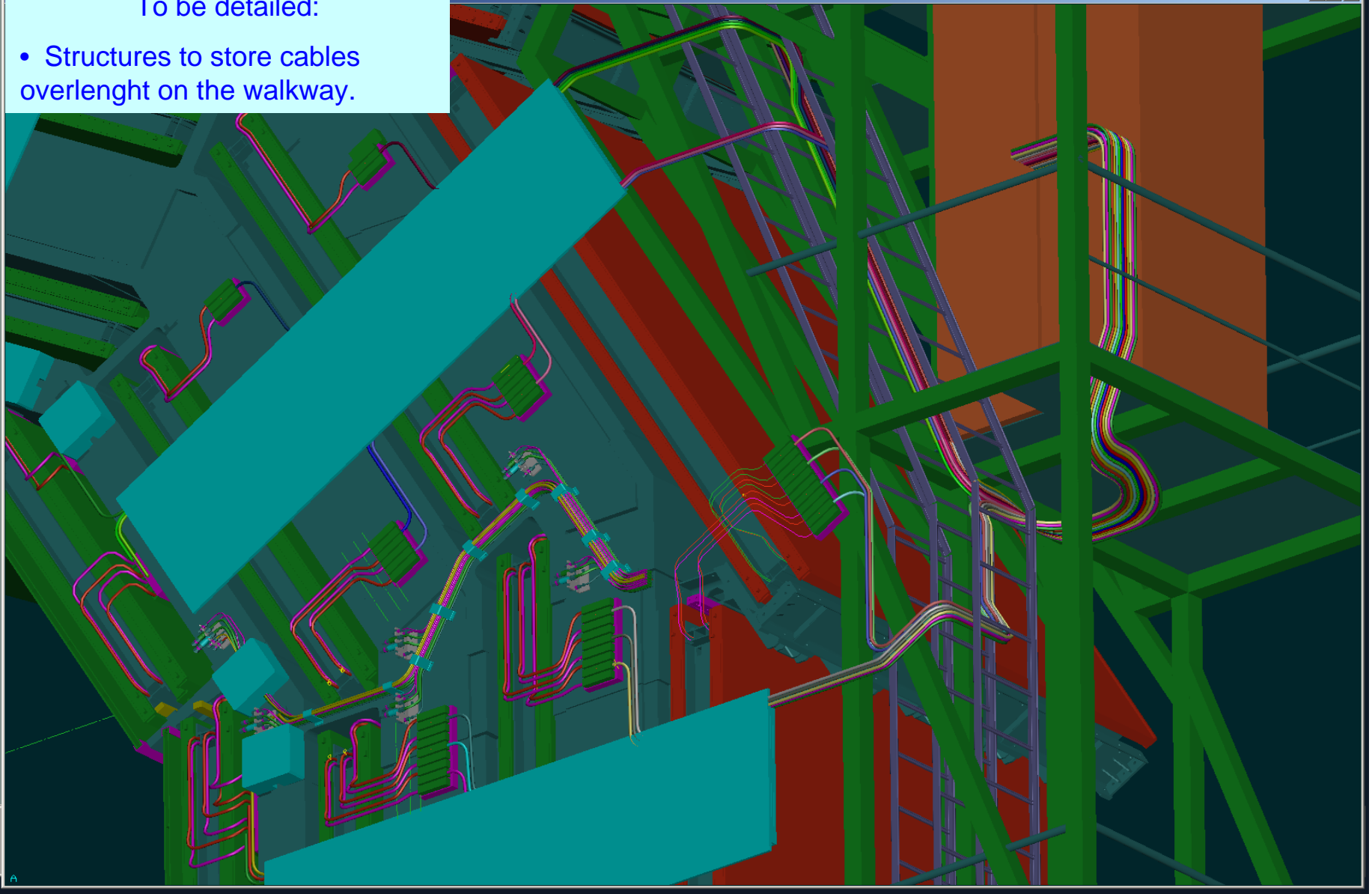

MB4 LV PC will be moved from the Honeycomb channel to the 3rd iron layer. Design in work.

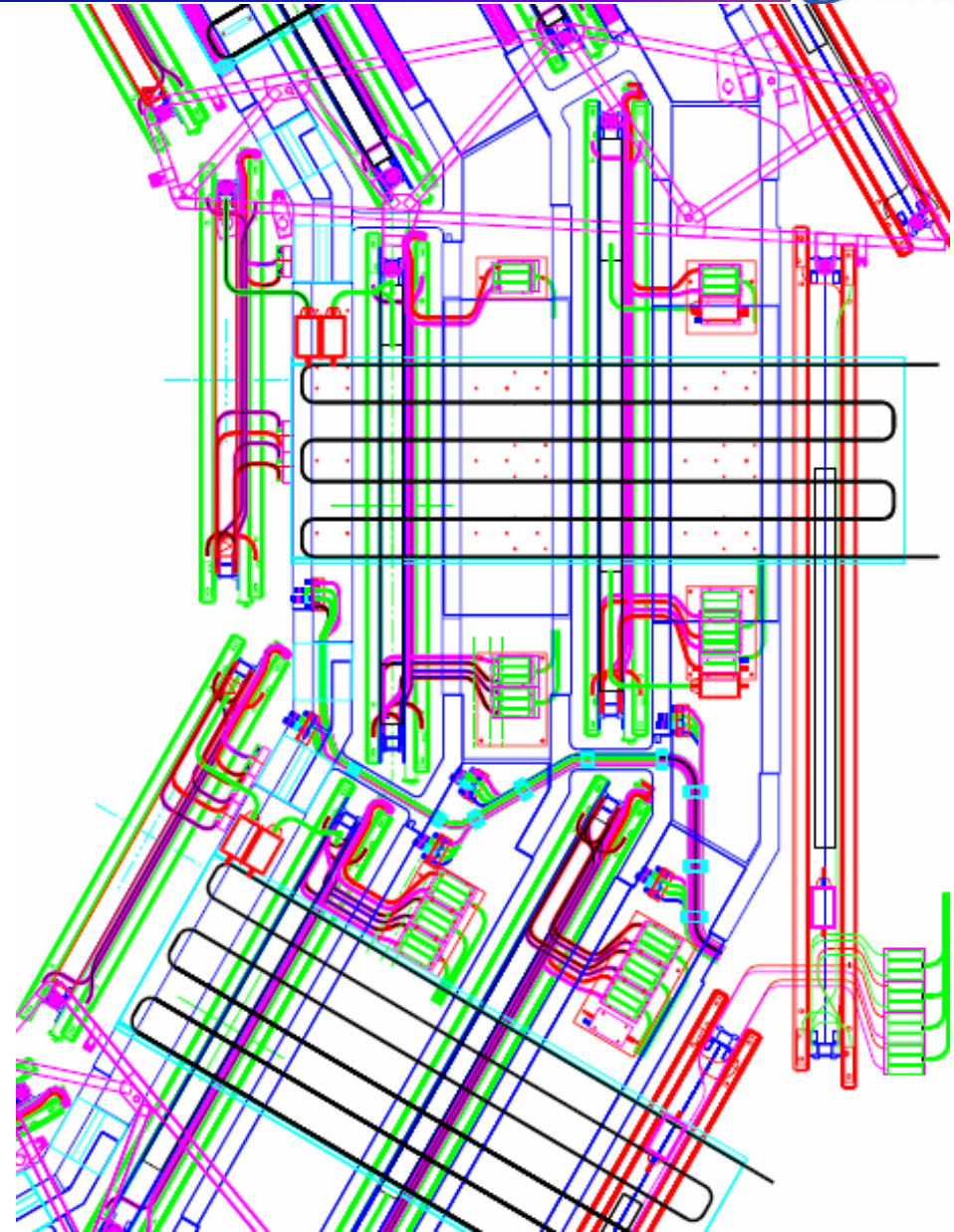
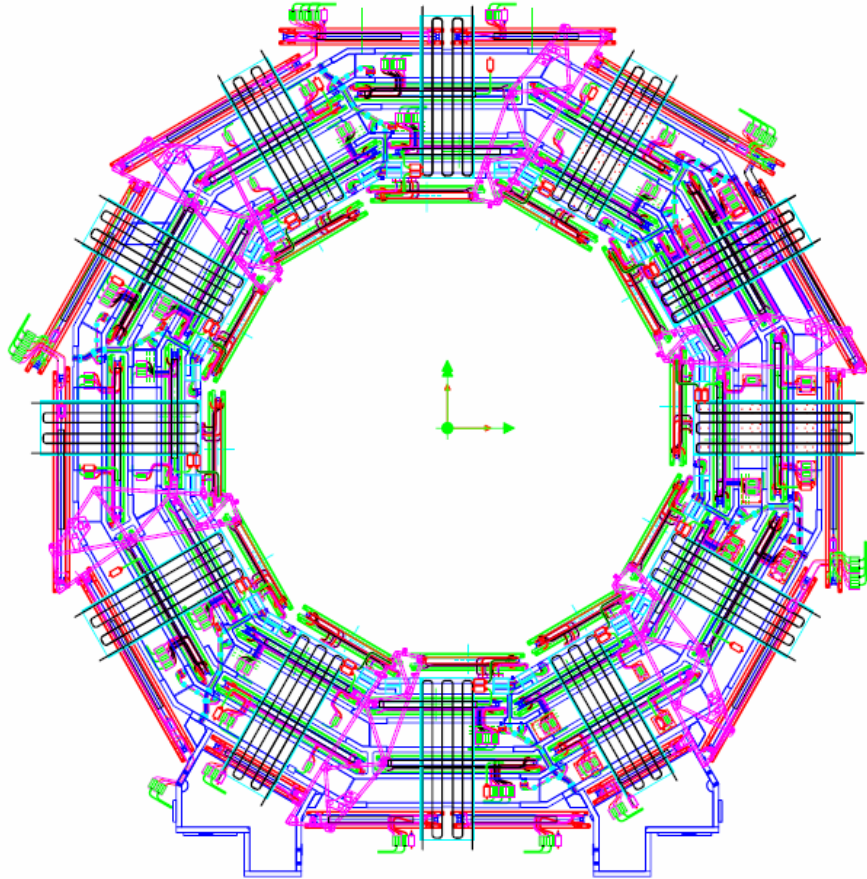

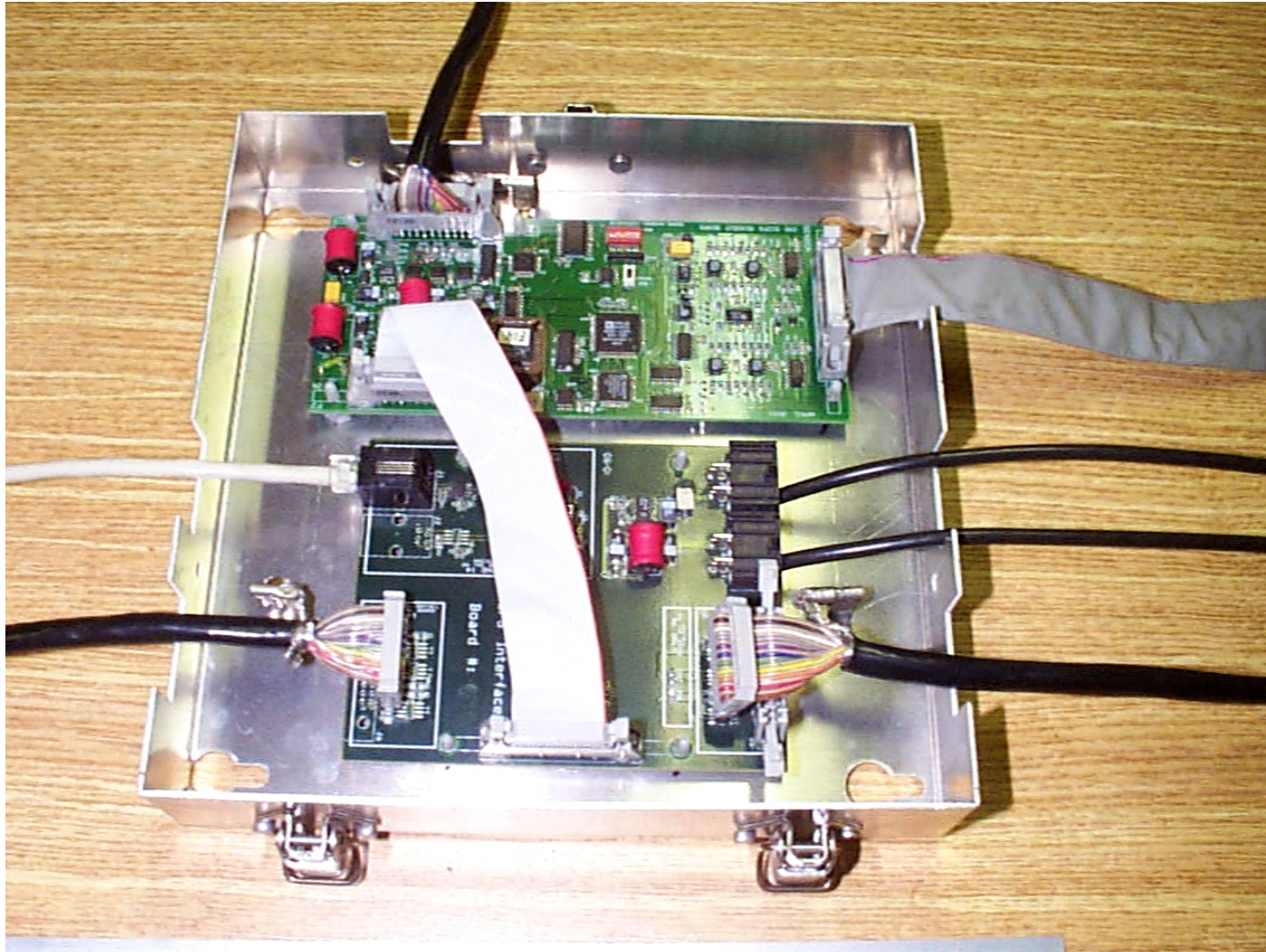

09.15.03

CABLE ID PROPOSAL - REVISED TO YB0 Racks Tower 3

- (A) 2 pair 28 AWG/STR Selfoil SH Belcan/SORBH
- (M) AWG/STR BC CABLE (6x2) no
- (N) Huber+Suhrer Multi-ALICE-24-7-2000PS 22v,Ord
- (F) 18 pair 0.028" centers FIBER/BRAID 28 AWG/STR Round Tolex-to Flat Cable (7A no) - AMPHENOL 160-2802-020
- (H) 4 pair 18AWG centers FIBER/BRAID 28 AWG/STR Round Tolex-to Flat Cable (7A no) - AMPHENOL 160-2802-020
- (I) 20 conductor 18WG centers AWG/STR Flat cable SH 2800/28 HF
- (J) 20 conductor 0.028" c-c Plated FIB. shielded Cable 28 AWG/STR
- (K) 20 conductor 18WG centers Plated FIB. shielded Cable 28 AWG/STR -3M Possible alternative to Round-to-Flat between MABS
- (L) 2 pair 0.028" centers FIBER/BRAID 28 AWG/STR Round-to-Flat Cable (8 no)

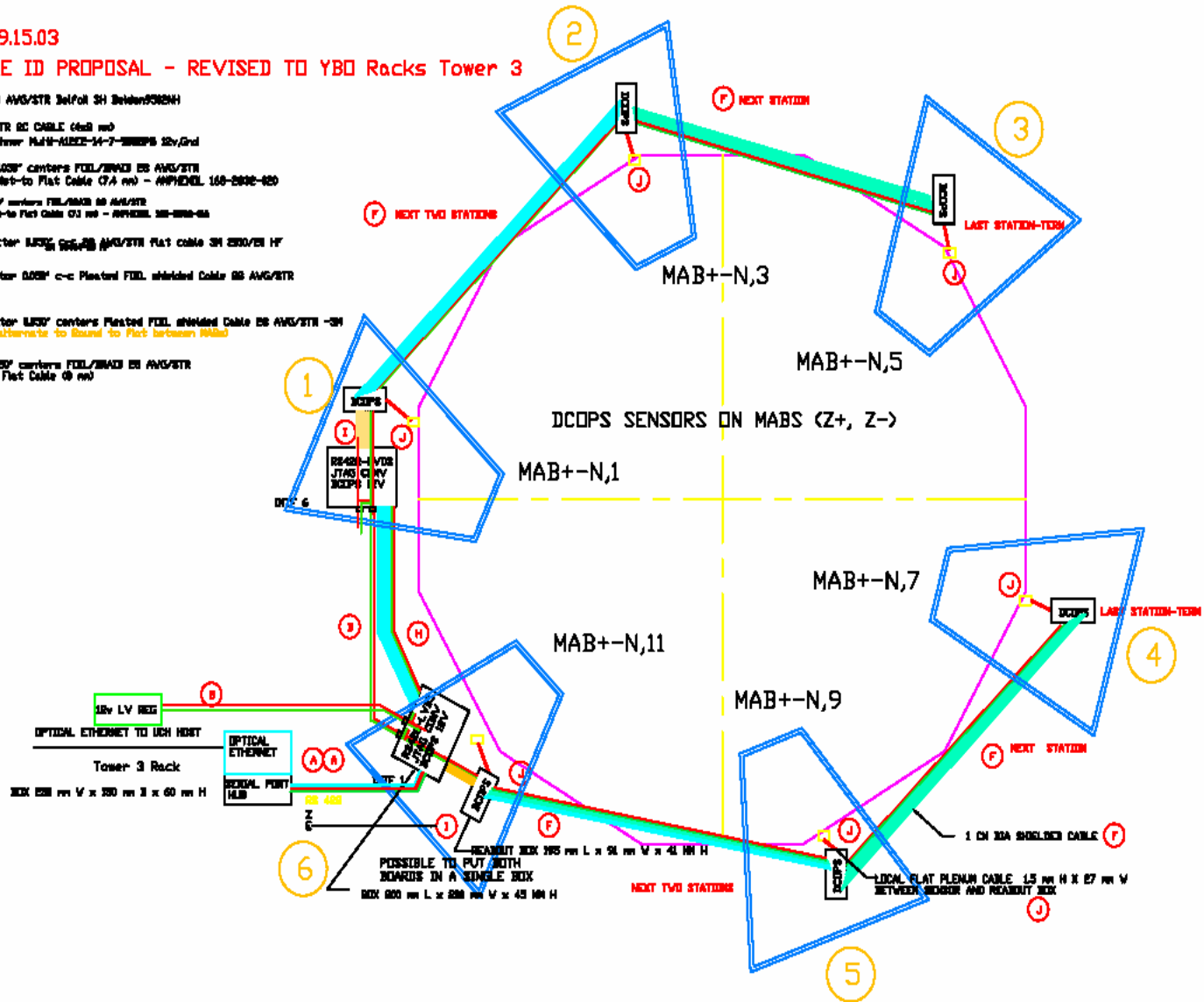

Location near the edge of 3rd iron blocks is preferred due to cable length constraints

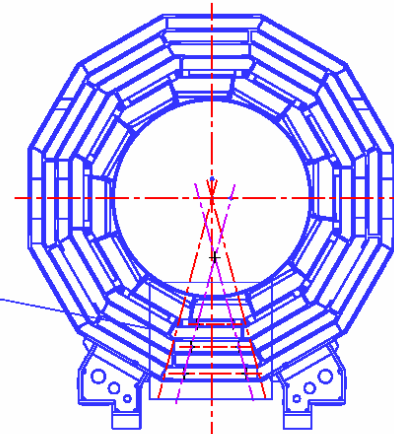
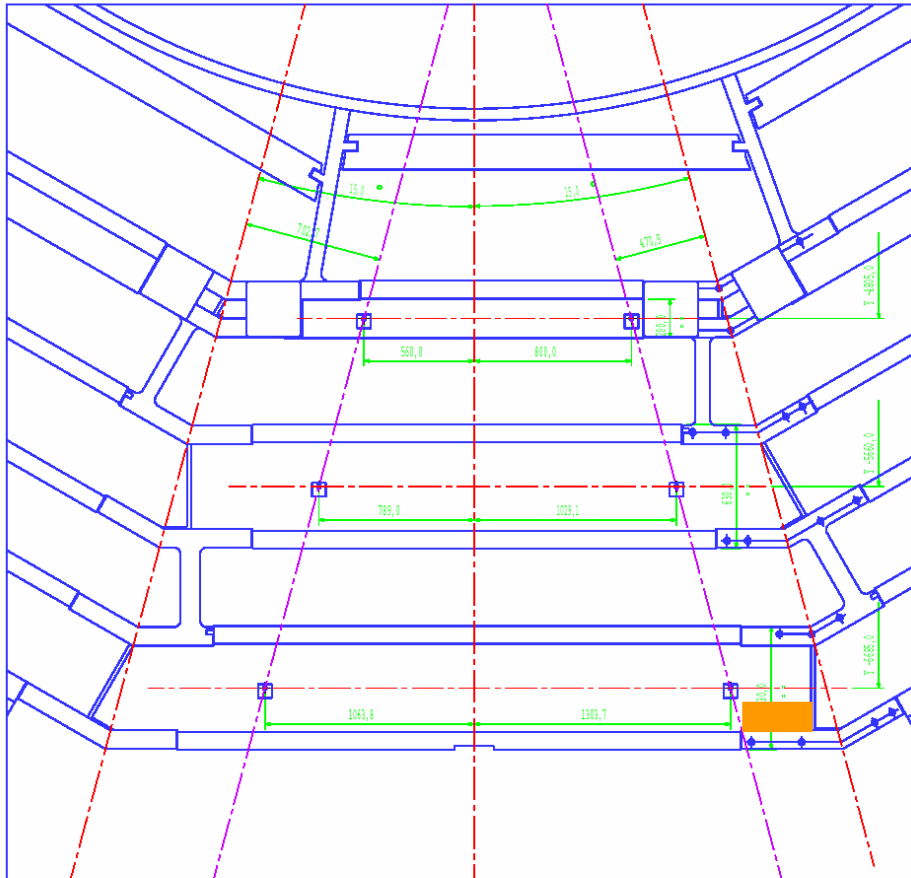

Yoke Barrel #0. Left side view.

Hall Probe position on sector # 10.

Vyacheslav KLONKHIN, Domenico BRITOLA.

PROPOSAL.

04 April 2003.

NO	2. BRITOLA	DATA			
DATA		DATA			DESCRIZIONE

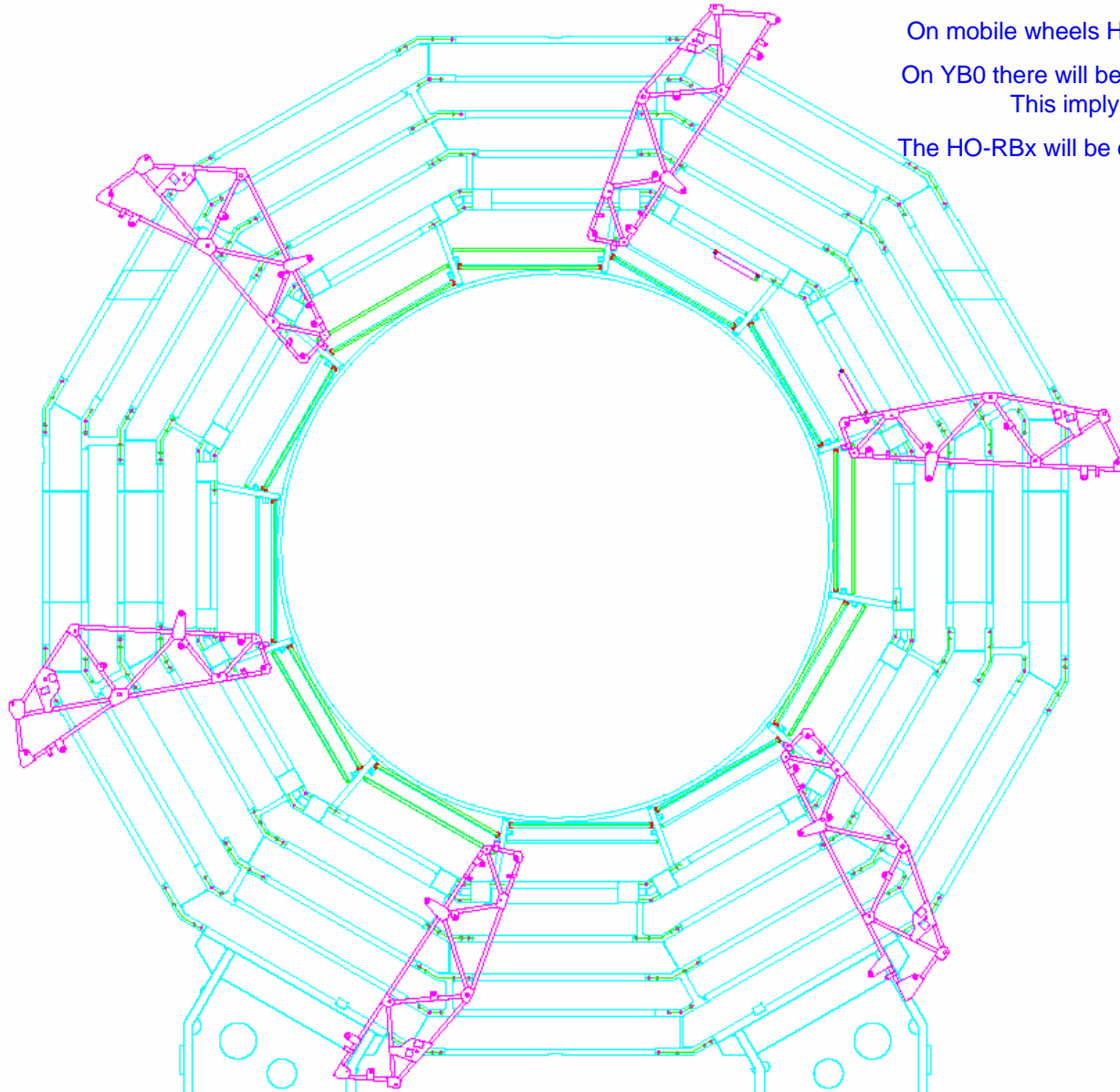

On mobile wheels HO-RBx position and fixing holes defined.

On YB0 there will be two layers of scintillator per each sector.
This imply one HO-RBx per each sector.

The HO-RBx will be on the services side (opposite side will be not accessible).

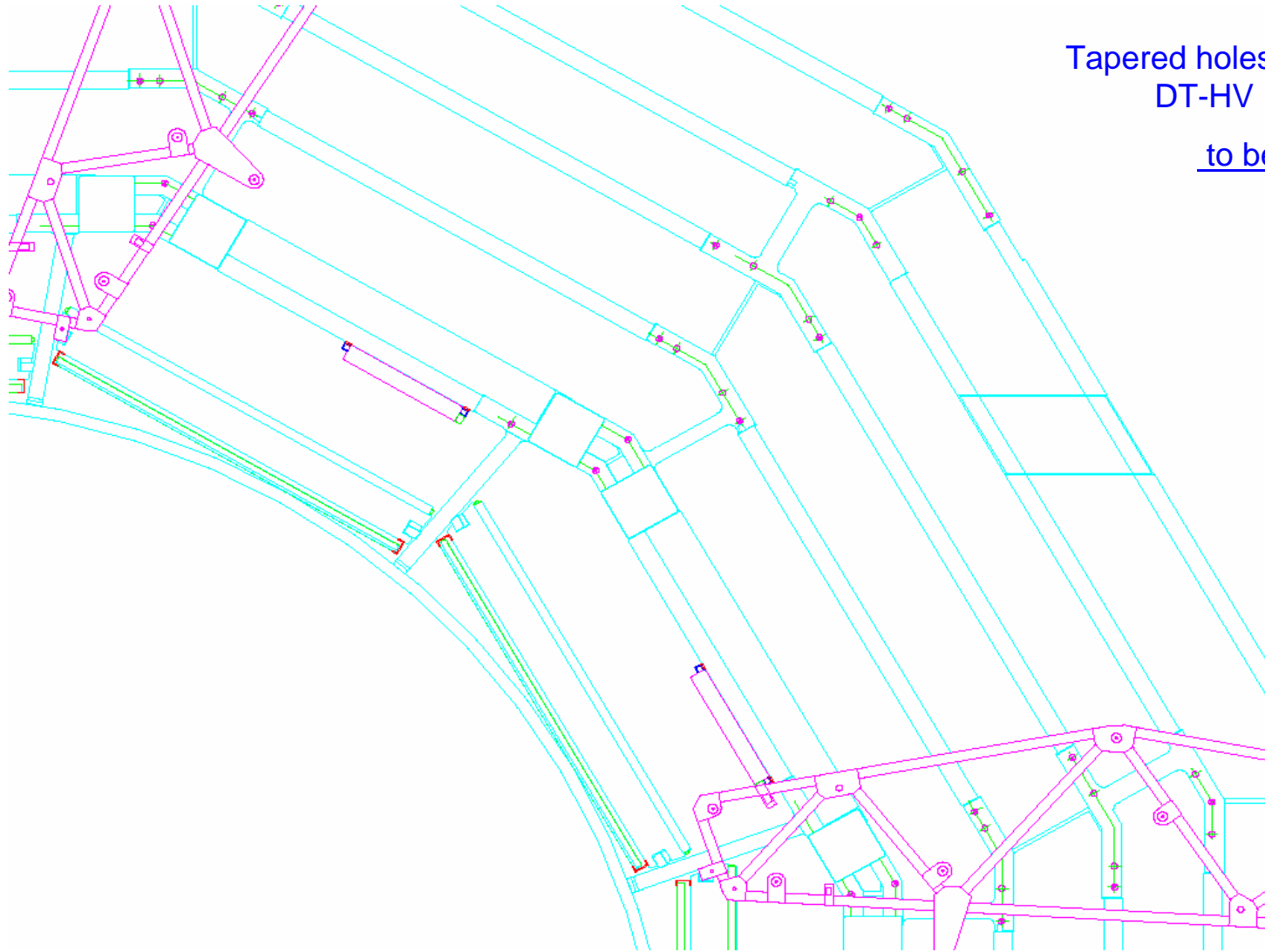

Tapered holes to fix HO-RBx and
DT-HV Patch Panels
to be defined.