

1. Services Integration
  - Gas and Cooling patch panels YB 0 S 10.
  - Cable way routing around feet.
  - Cable chain patch panels.
2. Vari patch panels components status
3. Cable way status
  - Radial
  - Periphery

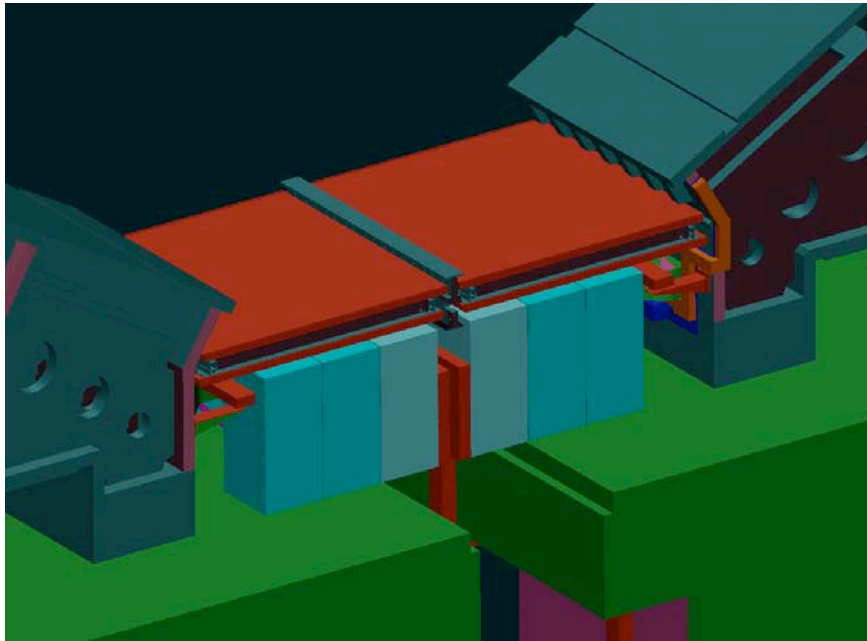

DT-RPC gas patch panels and  
cooling distributors

ECAL LV Racks between feet on YB0

→move away DTHV and Lv PP and  
DT-RPC gas-cooling p.d.  
New position t.b.d.

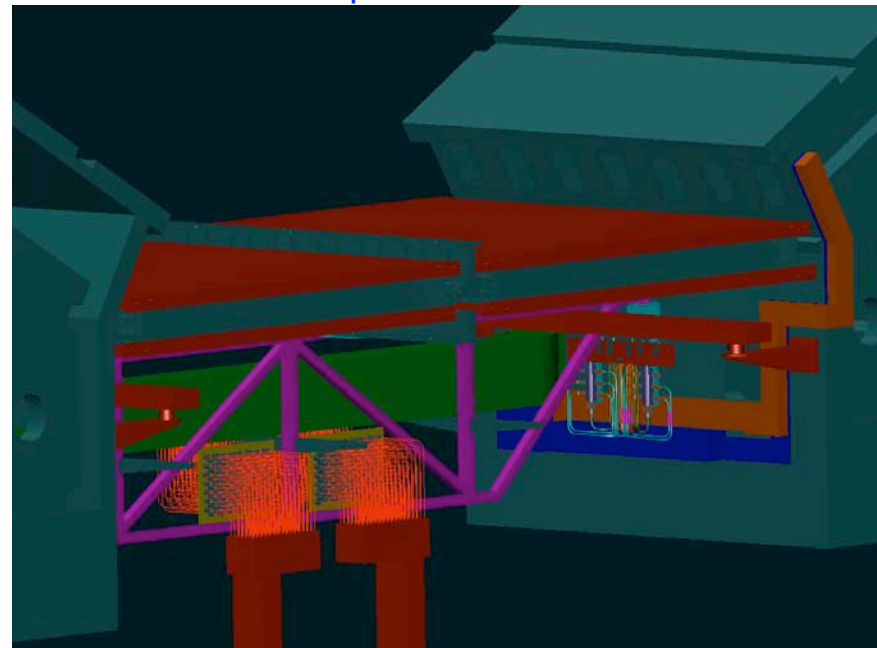





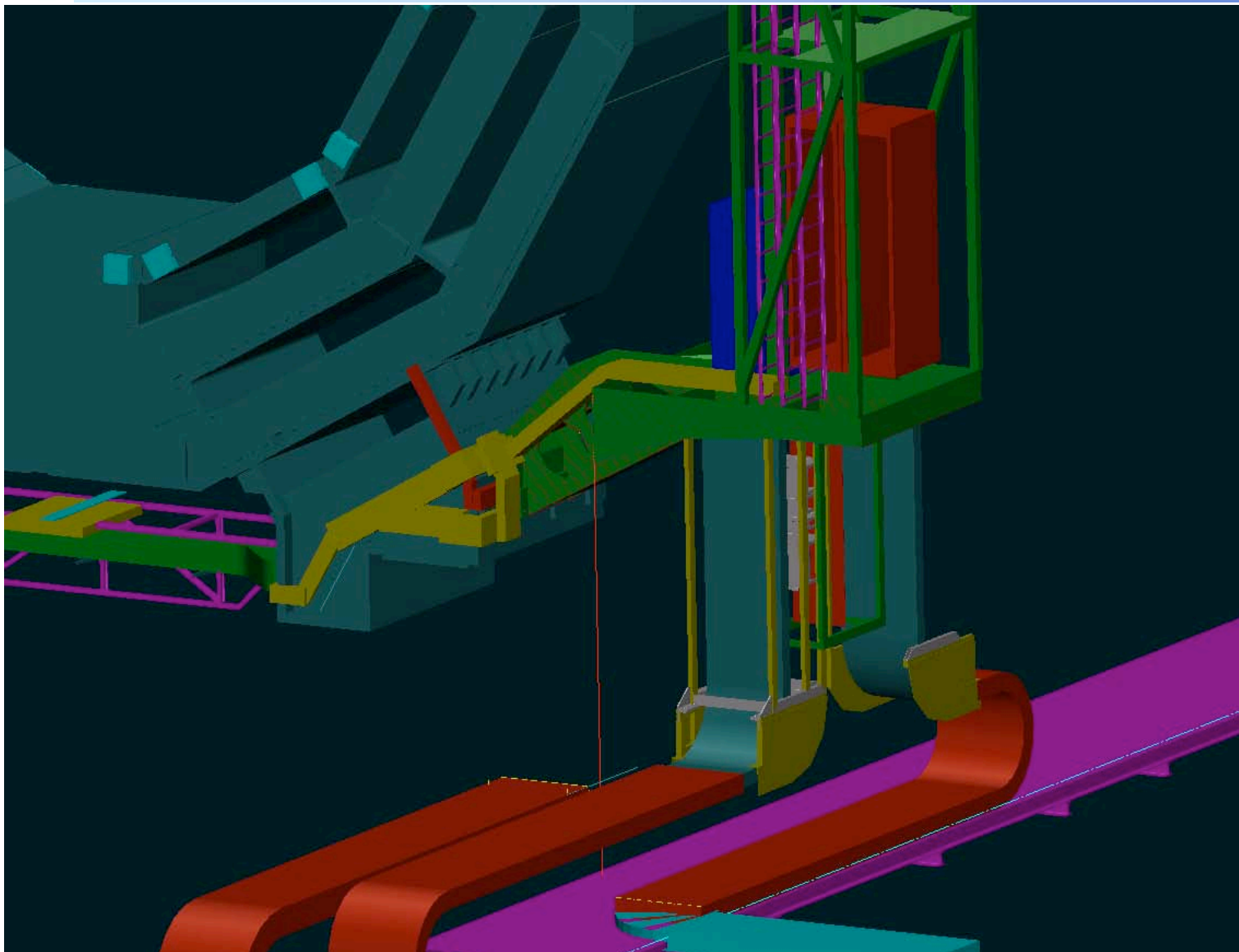

# 1<sup>st</sup> Rack Installation.

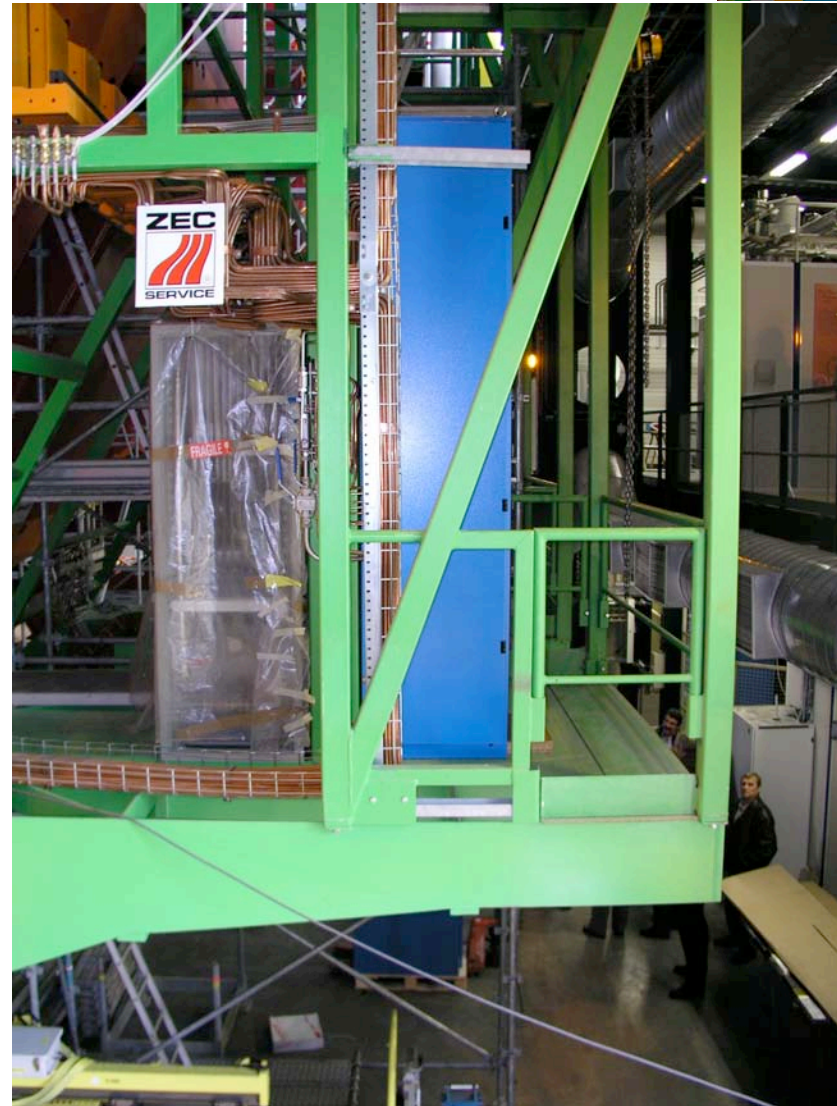





Muon Barrel. Radial Cables Ways and services components status

□	□	□
Services fixing tapered holes	MB1; 2; 3 :Completed on all the wheels.	MB4 : Desing in work
□	Note: Ground connection may require new holes on the iron !	□
MB1 fix plate rails	Installed on YB2	To be produced for all the remaining YB
□	□	□
HV fixing plate	□	□
HV MB1	In production for YB2.	To be produced for all the remaining YB
HV MB2/3	Partly installed on YB2.	To be produced for all the remaining. Order for all YB ?
□	□	□
HV MB4	Design in work	□
LV fixing plate	□	□
LV MB1/MB2	Design ready for manufacture	□
LV MB3	Partly installed on YB2.	□
LV MB4	Design in work	□
□	□	□
Wire mesh Cable ways	Defined. To be order	□
Fixing parts	Design ready for manufacture	□
Flexrail	Defined. To be order	□
Fixing parts	Design ready for manufacture	□
□	□	□
Services Cover/Thermal screen	Proposal. In work	□
□	□	□

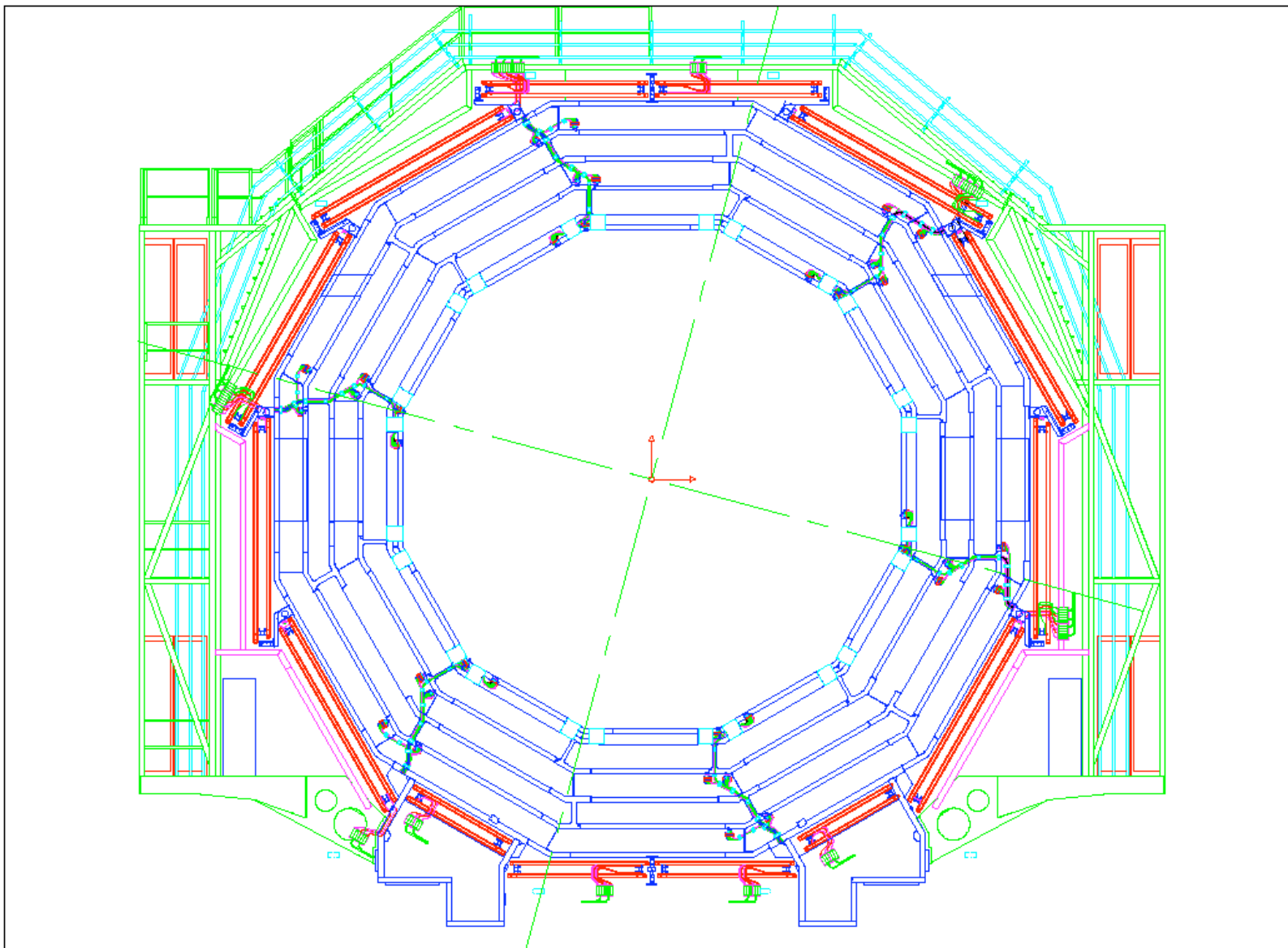



# Periphery cable way layout

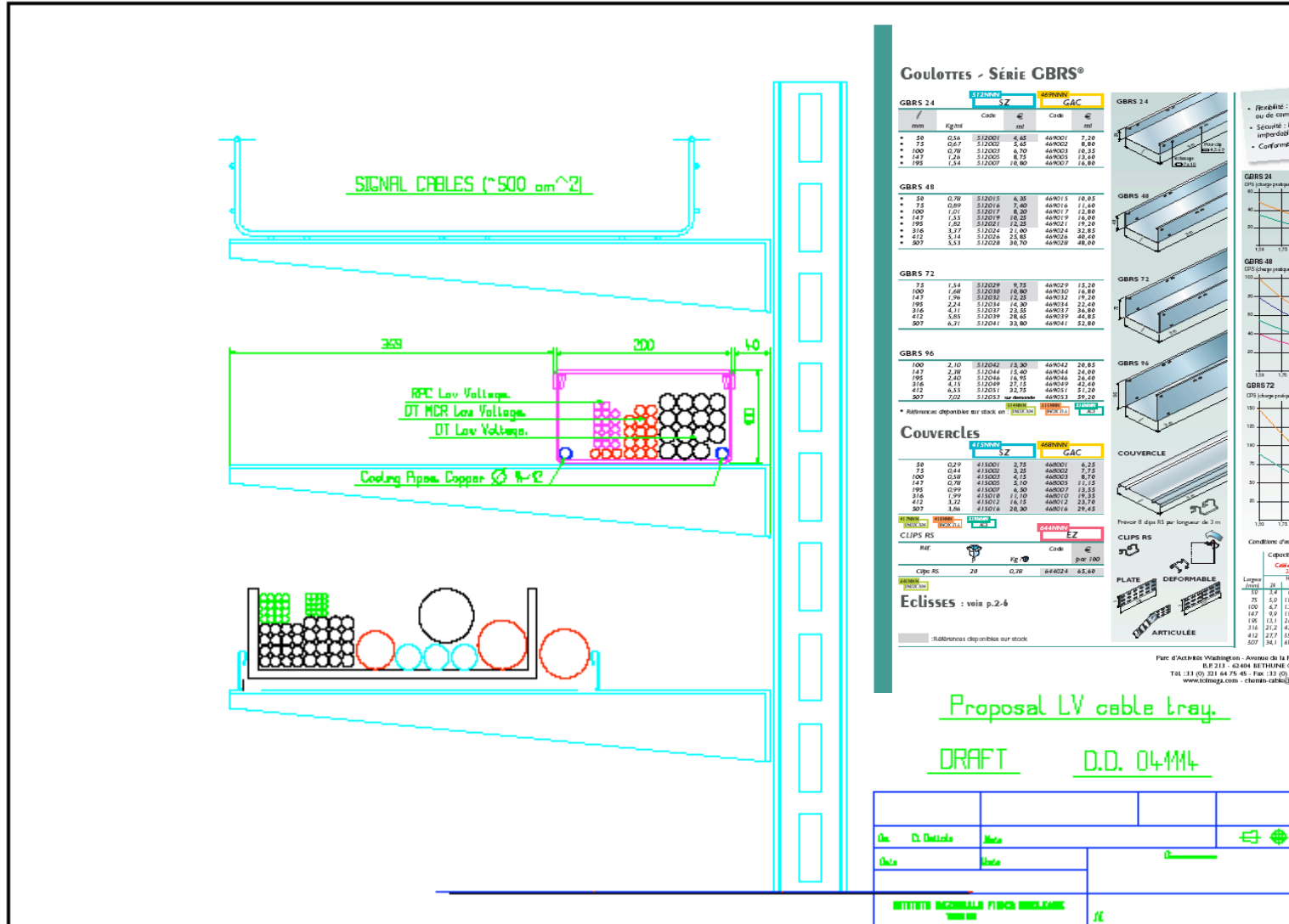

## Coulottes - SÉRIE GBRS®

GBRS 24		EZIMNY		S4IMNY		GAC	
mm	Rg/m	Code	IC	Code	IC	Code	IC
50	0,56	S12001	6,85	46R001	7,28		
75	0,67	S12002	8,05	46R002	8,89		
100	0,79	S12003	9,20	46R003	10,35		
125	0,91	S12004	10,35	46R004	11,80		
150	1,04	S12005	11,50	46R005	13,25		
175	1,16	S12006	12,65	46R006	14,70		
195	1,28	S12007	13,80	46R007	16,15		

GBRS 48		EZIMNY		S4IMNY		GAC	
mm	Rg/m	Code	IC	Code	IC	Code	IC
50	0,79	S12015	6,35	46R015	10,85		
75	0,89	S12016	7,50	46R016	11,80		
100	1,01	S12017	8,65	46R017	12,80		
125	1,13	S12018	9,80	46R018	13,80		
147	1,25	S12019	10,95	46R019	14,80		
165	1,37	S12020	12,10	46R020	15,80		
183	1,49	S12021	13,25	46R021	16,80		
201	1,61	S12022	14,40	46R022	17,80		
229	1,73	S12023	15,55	46R023	18,80		
257	1,85	S12024	16,70	46R024	19,80		
285	1,97	S12025	17,85	46R025	20,80		
313	2,09	S12026	19,00	46R026	21,80		
341	2,21	S12027	20,15	46R027	22,80		
369	2,33	S12028	21,30	46R028	23,80		
397	2,45	S12029	22,45	46R029	24,80		
425	2,57	S12030	23,60	46R030	25,80		

GBRS 72		EZIMNY		S4IMNY		GAC	
mm	Rg/m	Code	IC	Code	IC	Code	IC
75	1,54	S12029	9,75	46R029	15,20		
100	1,66	S12030	10,90	46R030	16,15		
125	1,78	S12031	12,05	46R031	17,10		
147	1,90	S12032	13,20	46R032	18,05		
165	2,02	S12033	14,35	46R033	19,00		
183	2,14	S12034	15,50	46R034	19,95		
201	2,26	S12035	16,65	46R035	20,90		
229	2,38	S12036	17,80	46R036	21,85		
257	2,50	S12037	18,95	46R037	22,80		
285	2,62	S12038	20,10	46R038	23,75		
313	2,74	S12039	21,25	46R039	24,70		
341	2,86	S12040	22,40	46R040	25,65		
369	2,98	S12041	23,55	46R041	26,60		
397	3,10	S12042	24,70	46R042	27,55		
425	3,22	S12043	25,85	46R043	28,50		
453	3,34	S12044	27,00	46R044	29,45		
481	3,46	S12045	28,15	46R045	30,40		
509	3,58	S12046	29,30	46R046	31,35		
537	3,70	S12047	30,45	46R047	32,30		
565	3,82	S12048	31,60	46R048	33,25		
593	3,94	S12049	32,75	46R049	34,20		
621	4,06	S12050	33,90	46R050	35,15		

GBRS 96		EZIMNY		S4IMNY		GAC	
mm	Rg/m	Code	IC	Code	IC	Code	IC
100	2,10	S12042	13,30	46R042	20,85		
125	2,22	S12043	14,45	46R043	21,80		
150	2,34	S12044	15,60	46R044	22,75		
175	2,46	S12045	16,75	46R045	23,70		
200	2,58	S12046	17,90	46R046	24,65		
225	2,70	S12047	19,05	46R047	25,60		
250	2,82	S12048	20,20	46R048	26,55		
275	2,94	S12049	21,35	46R049	27,50		
300	3,06	S12050	22,50	46R050	28,45		

COVERLES		EZIMNY		S4IMNY		GAC	
mm	Rg/m	Code	IC	Code	IC	Code	IC
50	0,27	41S001	2,75	46R001	6,25		
75	0,44	41S002	3,25	46R002	7,75		
100	0,61	41S003	3,75	46R003	9,25		
125	0,78	41S004	4,25	46R004	10,75		
150	0,95	41S005	4,75	46R005	12,25		
175	1,12	41S006	5,25	46R006	13,75		
200	1,29	41S007	5,75	46R007	15,25		
225	1,46	41S008	6,25	46R008	16,75		
250	1,63	41S009	6,75	46R009	18,25		
275	1,80	41S010	7,25	46R010	19,75		
300	1,97	41S011	7,75	46R011	21,25		
325	2,14	41S012	8,25	46R012	22,75		
350	2,31	41S013	8,75	46R013	24,25		
375	2,48	41S014	9,25	46R014	25,75		
400	2,65	41S015	9,75	46R015	27,25		
425	2,82	41S016	10,25	46R016	28,75		
450	2,99	41S017	10,75	46R017	30,25		
475	3,16	41S018	11,25	46R018	31,75		
500	3,33	41S019	11,75	46R019	33,25		
525	3,50	41S020	12,25	46R020	34,75		
550	3,67	41S021	12,75	46R021	36,25		
575	3,84	41S022	13,25	46R022	37,75		
600	4,01	41S023	13,75	46R023	39,25		
625	4,18	41S024	14,25	46R024	40,75		
650	4,35	41S025	14,75	46R025	42,25		
675	4,52	41S026	15,25	46R026	43,75		
700	4,69	41S027	15,75	46R027	45,25		
725	4,86	41S028	16,25	46R028	46,75		
750	5,03	41S029	16,75	46R029	48,25		
775	5,20	41S030	17,25	46R030	49,75		
800	5,37	41S031	17,75	46R031	51,25		
825	5,54	41S032	18,25	46R032	52,75		
850	5,71	41S033	18,75	46R033	54,25		
875	5,88	41S034	19,25	46R034	55,75		
900	6,05	41S035	19,75	46R035	57,25		
925	6,22	41S036	20,25	46R036	58,75		
950	6,39	41S037	20,75	46R037	60,25		
975	6,56	41S038	21,25	46R038	61,75		
1000	6,73	41S039	21,75	46R039	63,25		
1025	6,90	41S040	22,25	46R040	64,75		
1050	7,07	41S041	22,75	46R041	66,25		
1075	7,24	41S042	23,25	46R042	67,75		
1100	7,41	41S043	23,75	46R043	69,25		
1125	7,58	41S044	24,25	46R044	70,75		
1150	7,75	41S045	24,75	46R045	72,25		
1175	7,92	41S046	25,25	46R046	73,75		
1200	8,09	41S047	25,75	46R047	75,25		
1225	8,26	41S048	26,25	46R048	76,75		
1250	8,43	41S049	26,75	46R049	78,25		
1275	8,60	41S050	27,25	46R050	79,75		
1300	8,77	41S051	27,75	46R051	81,25		
1325	8,94	41S052	28,25	46R052	82,75		
1350	9,11	41S053	28,75	46R053	84,25		
1375	9,28	41S054	29,25	46R054	85,75		
1400	9,45	41S055	29,75	46R055	87,25		
1425	9,62	41S056	30,25	46R056	88,75		
1450	9,79	41S057	30,75	46R057	90,25		
1475	9,96	41S058	31,25	46R058	91,75		
1500	10,13	41S059	31,75	46R059	93,25		
1525	10,30	41S060	32,25	46R060	94,75		
1550	10,47	41S061	32,75	46R061	96,25		
1575	10,64	41S062	33,25	46R062	97,75		
1600	10,81	41S063	33,75	46R063	99,25		
1625	10,98	41S064	34,25	46R064	100,75		
1650	11,15	41S065	34,75	46R065	102,25		
1675	11,32	41S066	35,25	46R066	103,75		
1700	11,49	41S067	35,75	46R067	105,25		
1725	11,66	41S068	36,25	46R068	106,75		
1750	11,83	41S069	36,75	46R069	108,25		
1775	12,00	41S070	37,25	46R070	109,75		
1800	12,17	41S071	37,75	46R071	111,25		
1825	12,34	41S072	38,25	46R072	112,75		
1850	12,51	41S073	38,75	46R073	114,25		
1875	12,68	41S074	39,25	46R074	115,75		
1900	12,85	41S075	39,75	46R075	117,25		
1925	13,02	41S076	40,25	46R076	118,75		
1950	13,19	41S077	40,75	46R077	120,25		
1975	13,36	41S078	41,25	46R078	121,75		
2000	13,53	41S079	41,75	46R079	123,25		
2025	13,70	41S080	42,25	46R080	124,75		

Muon Barrel.  
Periphery Cables Ways components status

1st Layer		
Gas-Cooling		Completed
Spare cable tray	Cablofil wire mesh 100 X 150	To be order. Installation before March 05
	Detailed list of components in preparation.	
2nd Layer		
Cooled LV	Tolmega 100 X 200	Ordered. ( details of cooling circuits to be cleared )
DT-RPC Signal	Cablofil wire mesh 100 X 300	To be order. Installation before March 05
	Detailed list of components in preparation.	
3rd Layer		
DT-RPC HV	Cablofil wire mesh 100 X 500	To be order. Installation before March 05
	Detailed list of components in preparation.	

